

Louisa County, Iowa
Iowa South Zone (1402)
Horiz. Datum: NAD83(NSRS2007)
Vert. Datum: NAVD 1988
US Survey Feet
2007

Point Name: **502**

Designation: CBN control station "B 8" PID: MG0476

Northing: **489110.92sft** Easting: **2172928.34sft**

Orthometric Height: **753.17sft** Ellipsoid Height: **645.61sft** **Geoid03**

Latitude: **41°19'34.28701"N** Longitude: **91°33'39.59479"W**

Mapping Angle: **1°16'38"** Combination Scale Factor: **0.99991995**

Monument Type: The station is a CGS bench mark disk stamped "B 8 1930 753.312" and set in the top of a concrete post.

To Reach: ****See the current NGS data sheet for complete station description****

Date Printed August 9, 2000

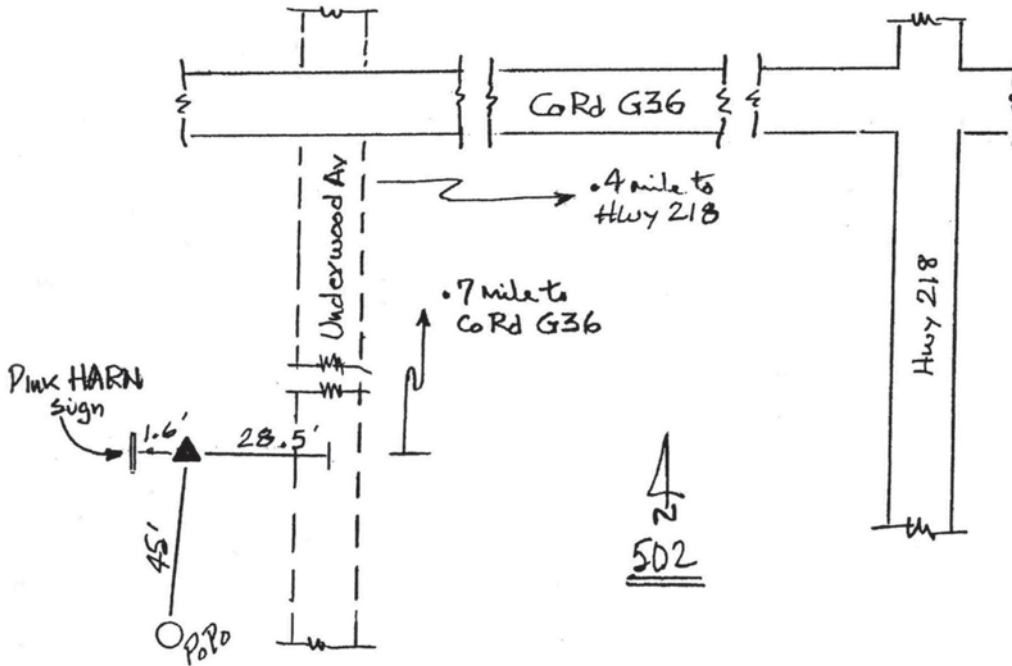

This document was prepared by DCI and GBC for use by Louisa County, Iowa.