

Louisa County, Iowa
 Horizontal Datum: **NAD 83(2011)** - Vertical Datum: **NAVD 1988**
 Iowa State Plane South Zone (1402)
 Iowa Regional Coordinate System Zone 14 Burlington TM
 US Survey Feet
2015

Point Name: **149**

Designation: 96-149 Washington Co GPS Control Pt. (set by ASI in 1996)

NAD 83(NA2011) Latitude: **N41°14'58.27352"** Longitude: **W91°29'06.62841"**
 NAVD 88 Ortho Height: **729.890** sft Ellip. Ht: **621.877**sft **Geoid12A**

Iowa South Zone (1402) Northing: **461656.871**sft Easting: **2194395.380**sft
 Mapping Angle: **1°19'38"** Combination Scale Factor: **0.999919056**

IaRCS Zone 14 Northing: **6564252.858**sft Easting: **24435328.182**sft
 Mapping Angle: **-00° 09' 18"** Combination Scale Factor: **0.999992992**

Monument Type: Berntsen Top Security Rod Monument with a 2-1/2" dia. domed survey cap and permanent magnet encased in a 5" dia. PVC pipe with a NGS style aluminum access cover.

To Reach: 45 ft. South of Old White Way (G52), 55 ft. East of Louisa-Washington Rd. Near the N.W. corner of Sec 6, T74N, R5W.

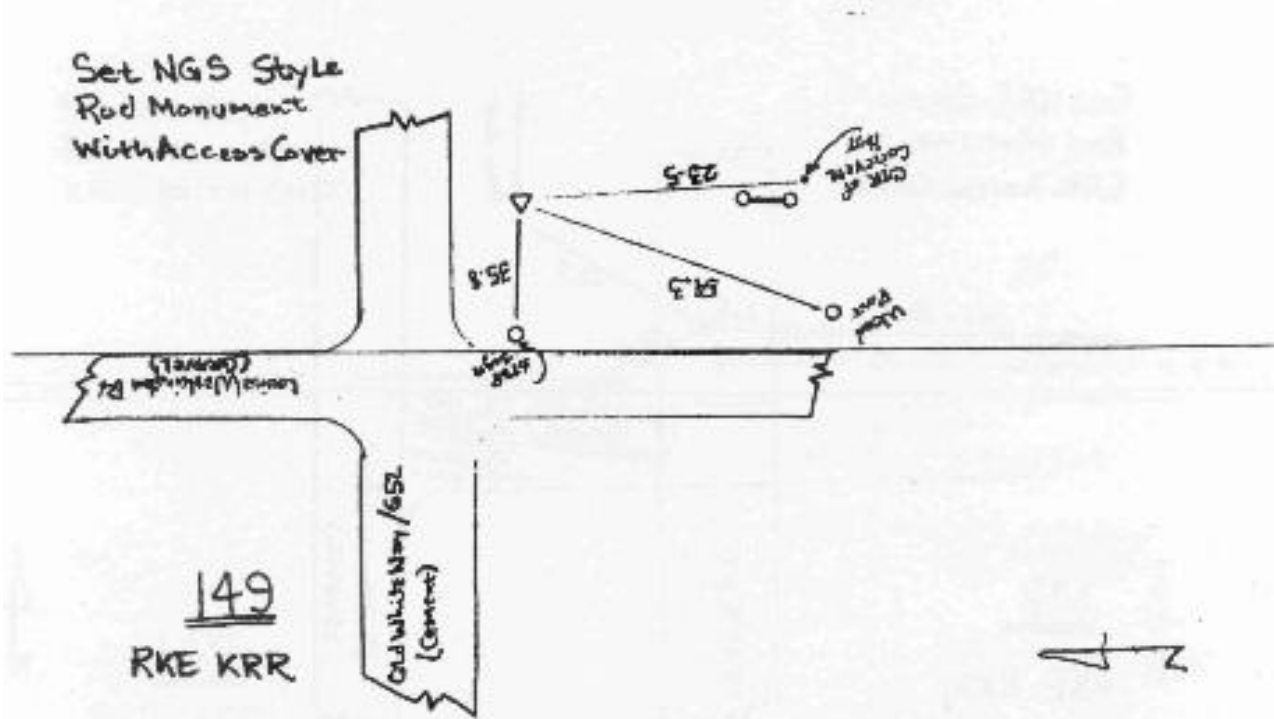

This document was prepared by Dan Corbin, Inc. on February 26, 2015 for Louisa County, Iowa