

**Louisa County, Iowa**  
 Horizontal Datum: **NAD 83(2011)** - Vertical Datum: **NAVD 1988**  
 Iowa State Plane South Zone (1402)  
 Iowa Regional Coordinate System Zone 14 Burlington TM  
 US Survey Feet  
**2015**

Point Name: **209**

**Designation:** 99-209 Des Moines Co GPS Control Pt. (set by ASI in 1999)

NAD 83(NA2011) Latitude: **N41°04'26.41745"** Longitude: **W91°22'14.17458"**

NAVD 88 Ortho Height: **724.800** sft Ellip. Ht: **616.279**sft **Geoid12A**

Iowa South Zone (1402) Northing: **398478.926**sft Easting: **2227455.875**sft

Mapping Angle: **1°24'09"** Combination Scale Factor: **0.999921404**

IaRCS Zone 14 Northing: **6500236.402**sft Easting: **24466745.901**sft

Mapping Angle: **-00° 04' 45"** Combination Scale Factor: **0.999989743**

**Monument Type:** Berntsen Top Security Rod Monument with a 2-1/2" dia. domed survey cap and permanent magnet encased in a 5" dia. PVC pipe with a NGS style aluminum access cover.

**To Reach:** 40ft S of 270th St, 28ft E of Des Moines-Henry Av. Near the NW cor of Sec 6 T72N R4W.

Date Printed July 30, 1999

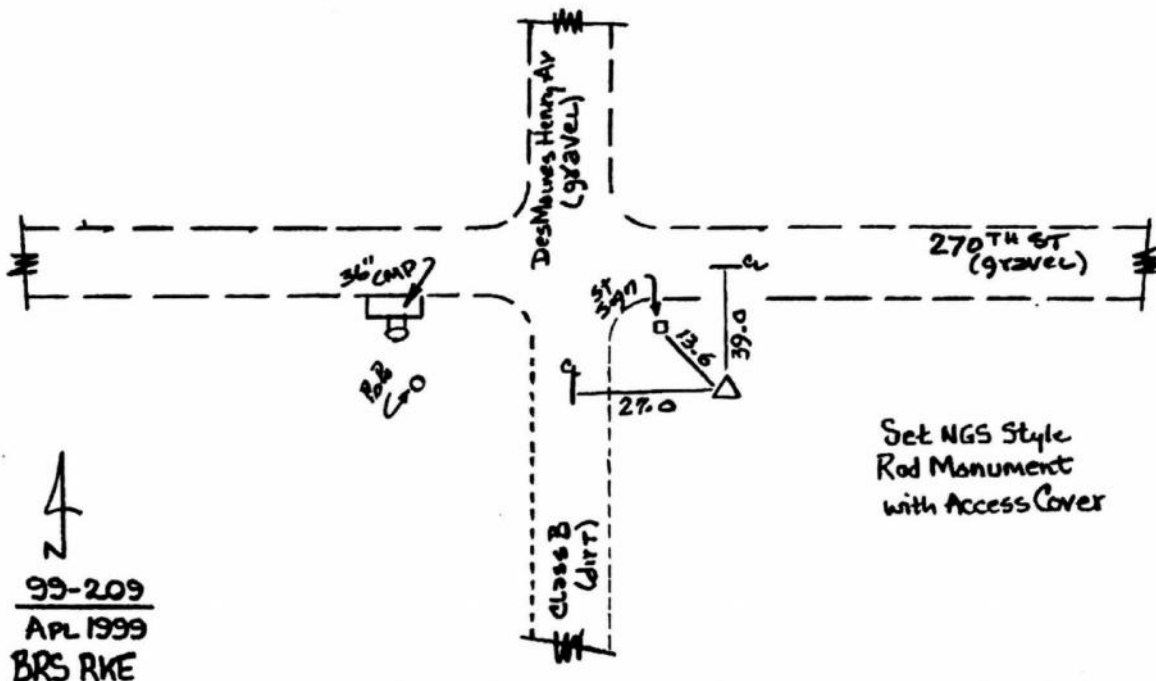

*This document was prepared by Dan Corbin, Inc. on February 26, 2015 for Louisa County, Iowa*