

Louisa County, Iowa
 Horizontal Datum: **NAD 83(2011)** - Vertical Datum: **NAVD 1988**
 Iowa State Plane South Zone (1402)
 Iowa Regional Coordinate System Zone 14 Burlington TM
 US Survey Feet
2015

Point Name: **449**

Designation: 2000-149 Muscatine Co GPS Control Pt. (set by ASI in 2000)

NAD 83(NA2011) Latitude: **N41°20'02.91641"** Longitude: **W91°06'32.18595"**
 NAVD 88 Ortho Height: **538.460** sft Ellip. Ht: **430.268**sft **Geoid12A**

Iowa South Zone (1402) Northing: **495097.424**sft Easting: **2296969.937**sft
 Mapping Angle: **1°34'30"** Combination Scale Factor: **0.999930536**

IaRCS Zone 14 Northing: **6595031.311**sft Easting: **24538740.536**sft
 Mapping Angle: **00° 05' 35"** Combination Scale Factor: **0.999999105**

Monument Type: Berntsen Top Security Rod Monument with a 2-1/2" dia. domed survey cap and permanent magnet encased in a 5" dia. PVC pipe with a NGS style aluminum access cover.

To Reach: near Louisa-Muscatine Co. Line also "X 61" apprx. 0.25 mi N of Cimarron Rd. in Louisa Co., 40ft E of "X 61" on line with dirt rd to W near S 1/4 cor of Sec 32 T76N R2W.

Date Printed August 9, 2000

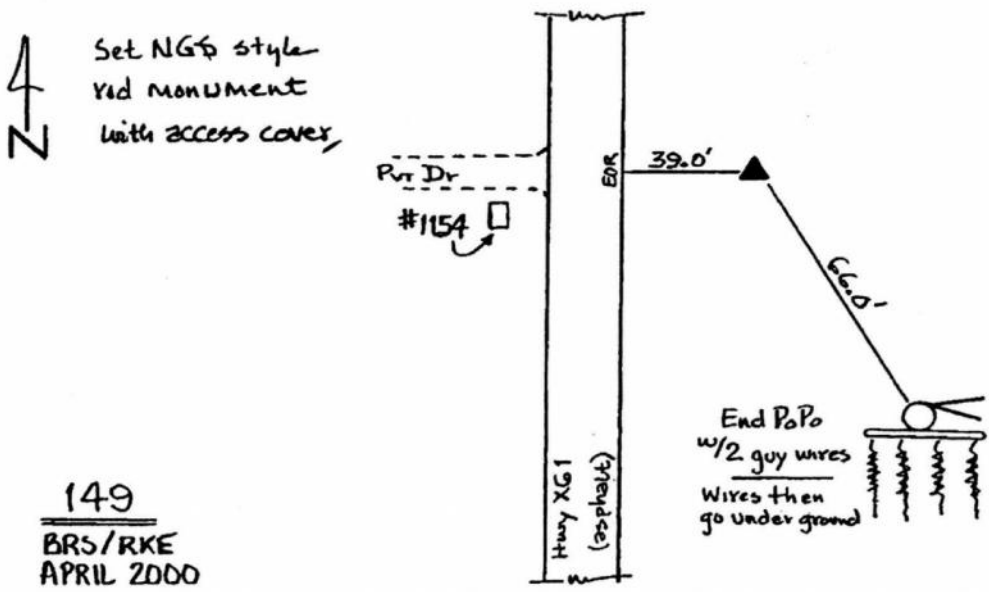

This document was prepared by Dan Corbin, Inc. on February 26, 2015 for Louisa County, Iowa