

**Louisa County, Iowa**  
 Horizontal Datum: **NAD 83(2011)** - Vertical Datum: **NAVD 1988**  
 Iowa State Plane South Zone (1402)  
 Iowa Regional Coordinate System Zone 14 Burlington TM  
 US Survey Feet  
**2015**

Point Name: **710**

**Designation:** USACE "Iowa River No. 2"

NAD 83(NA2011) Latitude: **N41°08'37.95069"** Longitude: **W91°03'37.62643"**  
 NAVD 88 Ortho Height: **547.870 sft** Ellip. Ht: **439.379sft** Geoid12A

Iowa South Zone (1402) Northing: **426170.922sft** Easting: **2312224.861sft**  
 Mapping Angle: **1°36'25"** Combination Scale Factor: **0.999927897**

IaRCS Zone 14 Northing: **6525728.384sft** Easting: **24552208.674sft**  
 Mapping Angle: **00° 07' 29"** Combination Scale Factor: **1.000000068**

**Monument Type:** The station is a USACE 3" dia. Aluminum disk stamped "Iowa River No. 2" set on a 5/8" rebar.

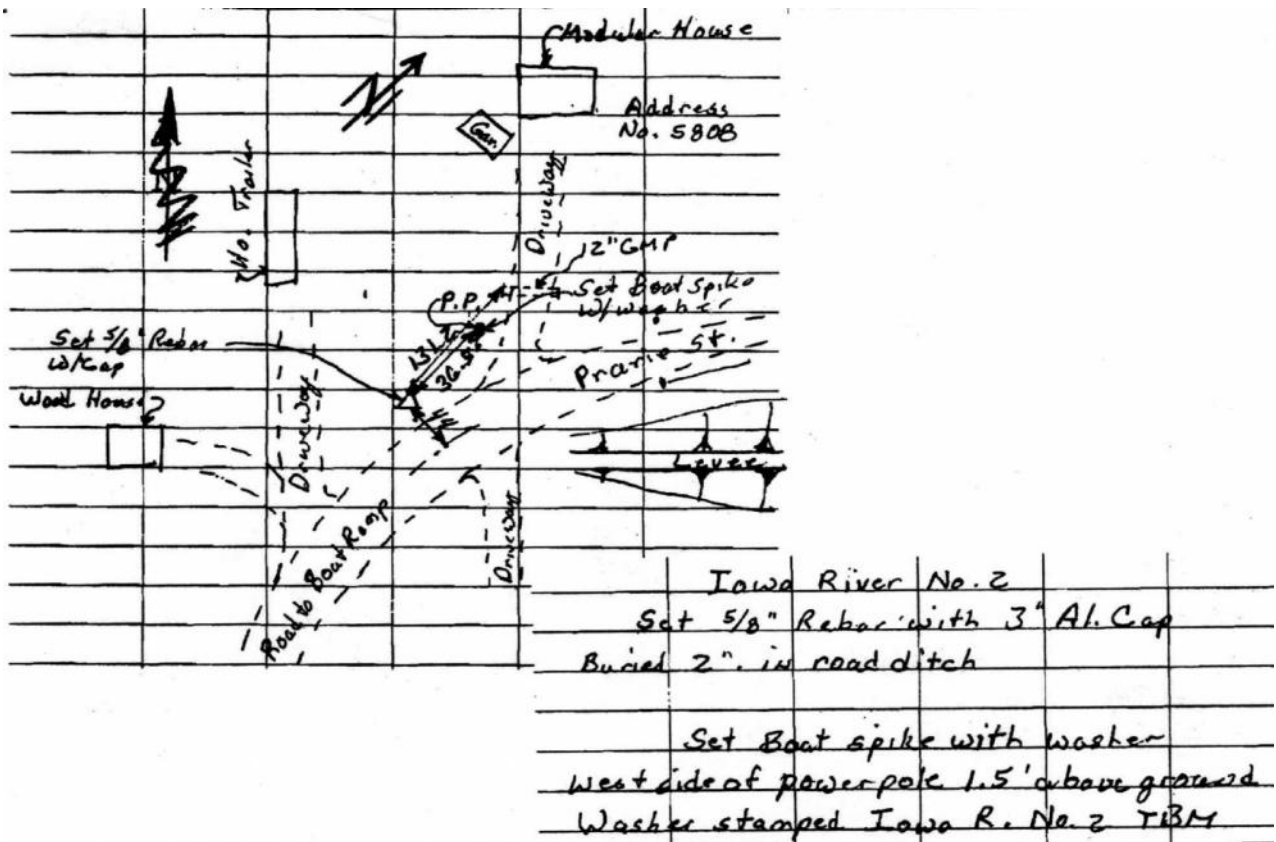

*This document was prepared by Dan Corbin, Inc. on February 26, 2015 for Louisa County, Iowa*