

1998
Marshall County, Iowa
Iowa North Zone (1401)
NAD_83(1996)

Point Number: 104

Northing: 3475982.02(Ft) Easting: 5012122.88(Ft)

Northing: 1059481.439(M) Easting: 1527698.108(M)

Elev: 1027.43(Ft) NAVD_88

Elev: 313.162(M) NAVD_88 Ellip Ht: 282.040(M) 96C Geoid Ht: -31.122(M)

Latitude: 42-02-06.019850 N Longitude: 93-09-55.816006 W

Theta: 0-13-36.13 Combination Factor: 0.99996164

Designation: 98-104 MARSHALL CO GPS CONTROL PT

Monument Type: 5/8" dia driven aluminum rod with a 2-1/2" dia aluminum cap and permanent magnet encased in a 5" dia PVC pipe with an aluminum access cover.

To Reach: 30ft W of Eastman Ave 300ft N of Sec Line near the S Quarter Cor of Sec 34 T84N R20W

Date Printed December 18, 1998

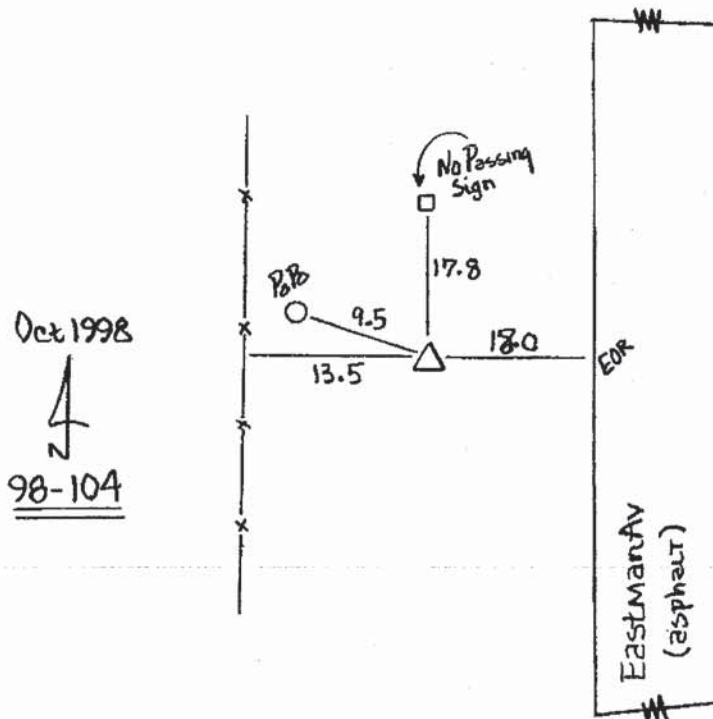

Note: Point 98-104 is located 1 mile South of Main St Rd and 300 ft North of Section Line.

Set NGS Style
Rod Monument
with Access Cover