

Mills County, Iowa
 Horizontal Datum: **NAD 83(2011)** - Vertical Datum: **NAVD 1988**
 Iowa State Plane South Zone (1402)
 Iowa Regional Coordinate System, Zone 6 Council Bluffs
 US Survey Feet
2016

Point Name: **1008**

Designation: CBN horiz. & 1st order vertical "J 180" PID: MJ1402

NAD 83(NA2011) Latitude: **N41°08'56.89986"** Longitude: **W95°48'44.50257"**
 NAVD 88 Ortho Height: **977.310sft** Ellip. Ht: **887.336sft** Geoid12A

Iowa South Zone (1402) Northing: **427131.290sft** Easting: **1003675.840sft**
 Mapping Angle: **-1°31'23"** Combination Scale Factor: **0.999906437**

laRCS Zone 6 Northing: **6927606.214sft** Easting: **16478233.883sft**
 Mapping Angle: **-00° 03' 07"** Combination Scale Factor: **0.999997037**

Monument Type: The station is a stainless steel rod set flush, with access to the datum point through a 5-inch NGS logo cap stamped "J 180 1989"

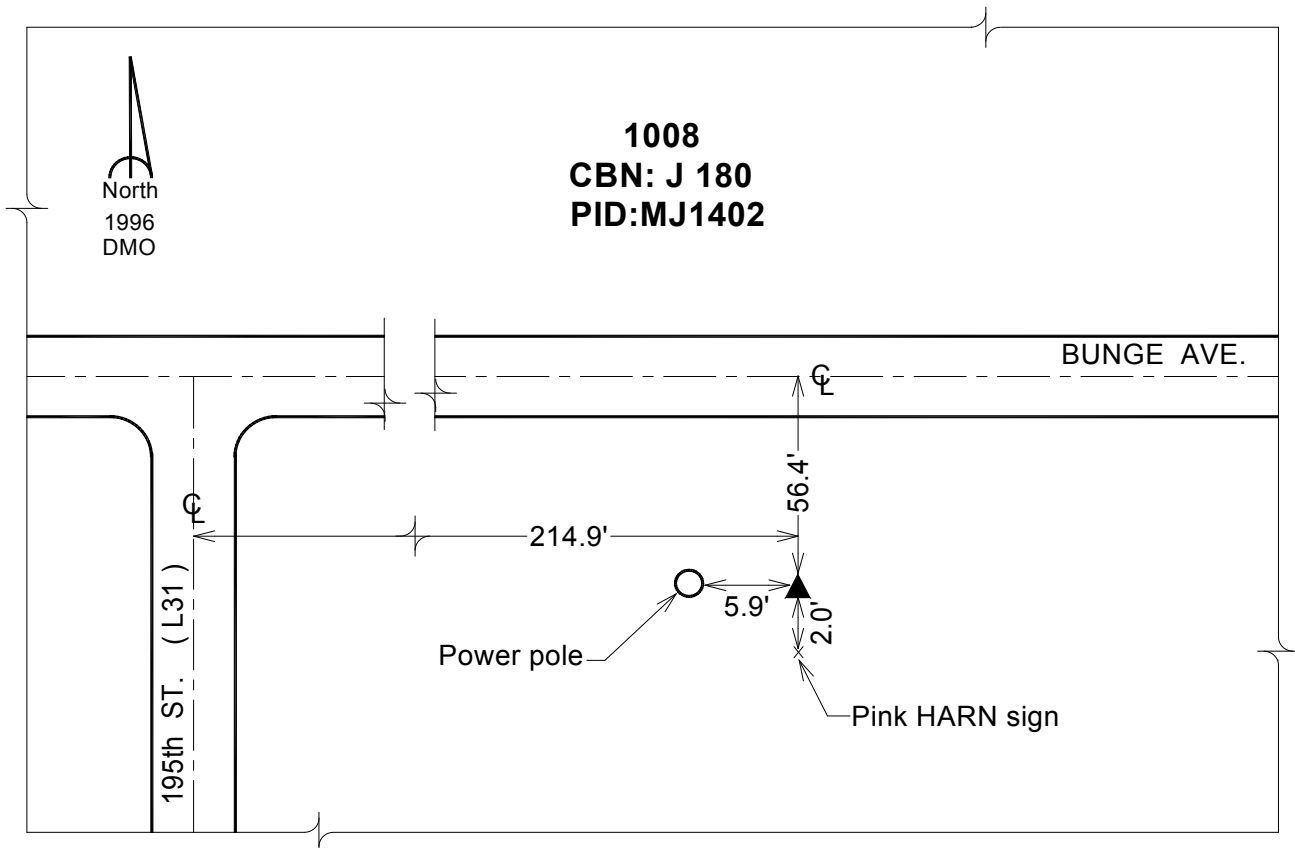

This document was prepared by Dan Corbin, Inc. on February 8, 2016 for Mills County, Iowa.