

**Mills County, Iowa**  
Horizontal Datum: **NAD 83(2011)** - Vertical Datum: **NAVD 1988**  
Iowa State Plane South Zone (1402)  
Iowa Regional Coordinate System, Zone 6 Council Bluffs  
US Survey Feet  
**2016**

Point Name: **1020**

**Designation:** TBM near NGS 2nd order vert. "P 97" PID: MJ0655

NAD 83(NA2011) Latitude: **N41°01'51.62265"** Longitude: **W95°36'16.75664"**  
NAVD 88 Ortho Height: **1026.670sft** Ellip. Ht: **934.264sft** Geoid12A

**Iowa South Zone (1402)** Northing: **382651.622sft** Easting: **1059817.876sft**  
Mapping Angle: **-1°23'11"** Combination Scale Factor: **0.999908166**

**IaRCS Zone 6** Northing: **6884578.633sft** Easting: **16535504.376sft**  
Mapping Angle: **00° 05' 04"** Combination Scale Factor: **0.999995687**

**Monument Type:** The station is a CGS bench mark disk stamped "P 97 1935" and set vertically in the east face of a concrete pillar.

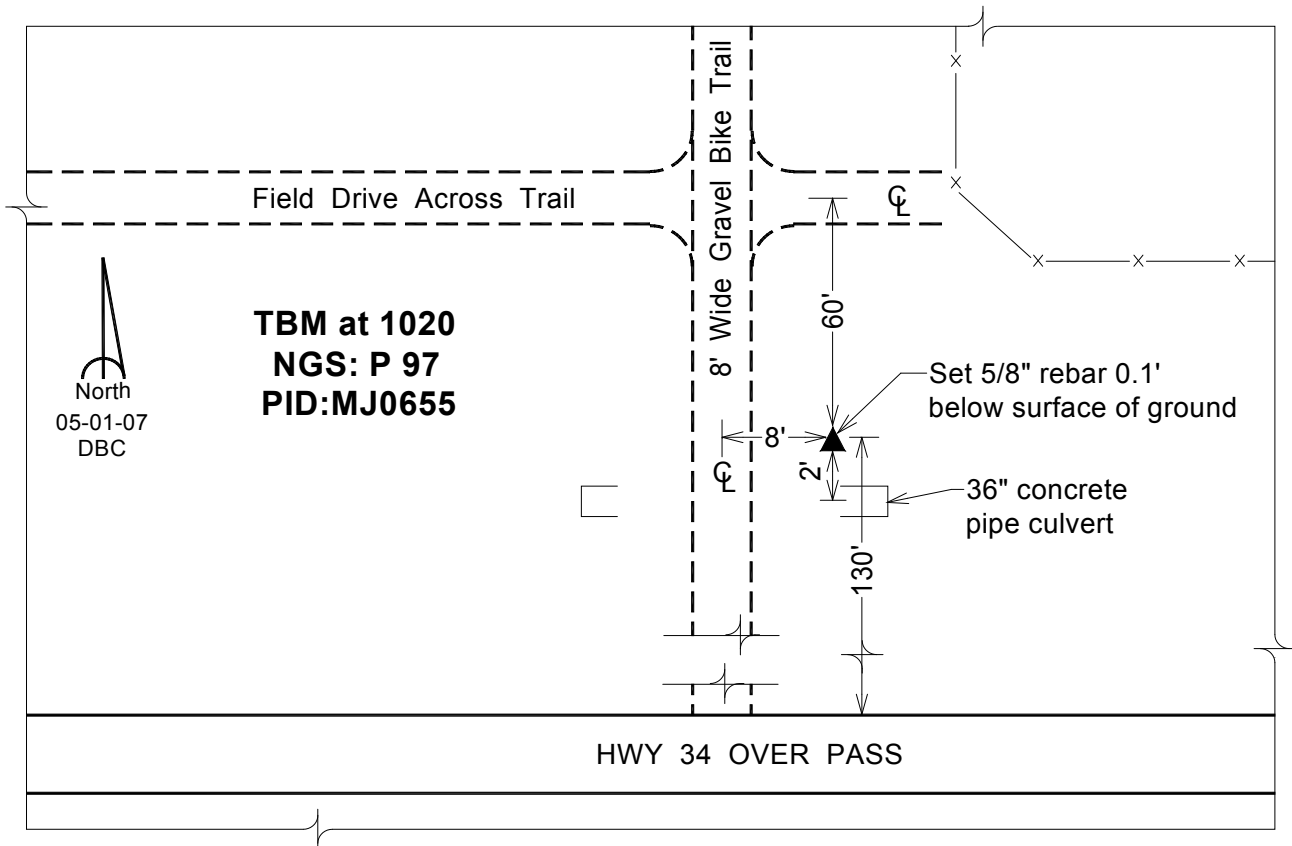

*This document was prepared by Dan Corbin, Inc. on February 8, 2016 for Mills County, Iowa.*