

Mitchell County, Iowa
Iowa North Zone (1401)
Horiz. Datum: NAD83(1996)
Vert. Datum: NAVD 1988
US Survey Feet
2006

Point Name: **707**

Designation: CBN 2nd Order vertical control station. PID:OO0274 Designation: N 40

Northing: **3950068.25sft** Easting: **5086712.02sft**

Orthometric Height: **1192.45sft** Ellipsoid Height: **1094.93sft** **Geoid03**

Latitude: **43°20'04.82996"N** Longitude: **92°52'41.22729"W**

Mapping Angle: **0°25'17"** Combination Scale Factor: **0.99996090**

Monument Type: The station is a CGS survey disk stamped "N 40 1934" and set in top of a concrete monument.

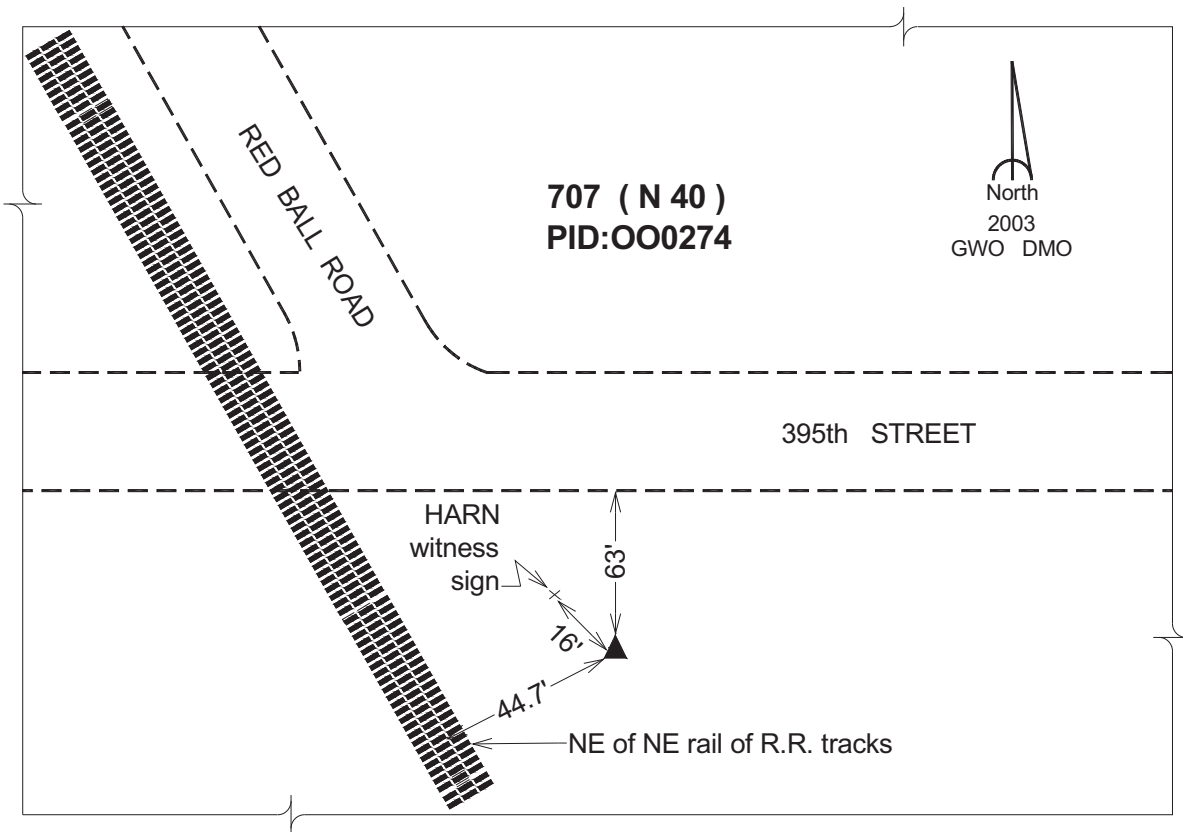

This document was prepared by DCI and GBC for use by Mitchell County, Iowa.