

GPS SURVEY MARK DESCRIPTION

GIS MAPPING BY:
THE SIDWELL COMPANY
WEST CHICAGO, ILLINOIS

THE OFFICE OF THE
COUNTY ENGINEER
MONROE COUNTY, IOWA

DESIGNATION 731930 4 GPS No. 6003 COUNTY MONROE STATE IOWA

LOCATED IN SECTION 30 TWP 73 N RGE 19 W USGS QUAD MAP WELLER

TO REACH FROM THE INTERSECTION OF U.S. HIGHWAY 34 AND COUNTY ROAD S65, NORTHWEST OF MELROSE;
GO NORTH ON S65 FOR 5.0 MILES TO COUNTY ROAD H32; THEN WEST FOR 1.5 MILES AT A "T" INTERSECTION
AT THE LUCAS - MONROE COUNTY LINE; THEN NORTHERLY 2.15 MILES ON A GRAVEL ROAD TO MARK.

TYPE OF MARK 3-1/4" ALUMINUM DISK SET IN 12" DIAMETER POURED-IN-PLACE CONCRETE MONUMENT.

RECOVERED SET BY DENI ASSOCIATES, INC., FT. MYERS, FL DATE OCTOBER 1996

HORIZONTAL VALUES ORIGINATED ON ORDER "B" IOWA HIGH ACCURACY REFERENCE NETWORK (HARN) CONTROL ESTABLISHED BY THE NATIONAL GEODETIC SURVEY AND BASED ON THE NORTH AMERICAN DATUM OF 1983, 1996 ADJUSTMENT.

IOWA COORDINATE SYSTEM, SOUTH ZONE GRID SCALE FACTOR: 0.99994984

COORDINATES (US FEET)	COORDINATES (METERS)
NORTHING (Y) <u>401786.22</u>	NORTHING (Y) <u>122464.685</u>
EASTING (X) <u>1751182.20</u>	EASTING (X) <u>533761.402</u>

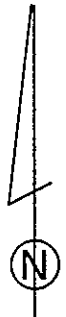
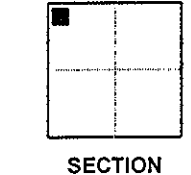
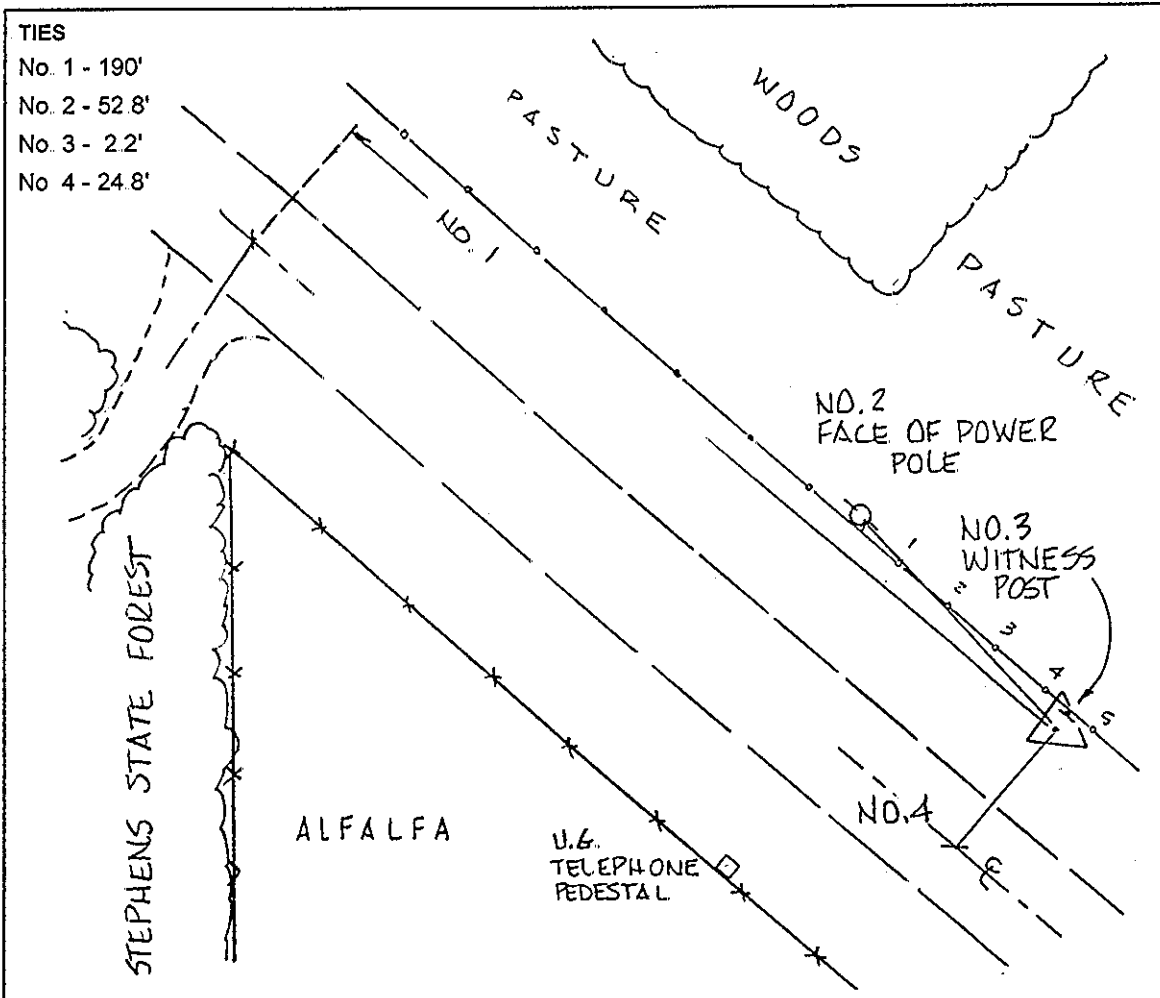

SKETCH
BY DSW
DENI 9609001