

GPS SURVEY MARK DESCRIPTION

GIS MAPPING BY:
THE SIDWELL COMPANY
WEST CHICAGO, ILLINOIS

THE OFFICE OF THE
COUNTY ENGINEER
MONROE COUNTY, IOWA

DESIGNATION 721912 3 GPS No. 6018 COUNTY MONROE STATE IOWA

LOCATED IN SECTION 12 TWP 72 N RGE 19 W USGS QUAD MAP HITEMAN

TO REACH FROM THE INTERSECTION OF U.S. HIGHWAY 34 AND COUNTY ROAD T13, WEST OF GEORGETOWN;
GO WESTERLY AND NORTHWESTERLY FOR 3.35 MILES ON T13 TO DIRT (LEVEL B) ROAD EAST; THEN EAST
FOR 0.95 MILE TO MARK.

TYPE OF MARK 3-1/4" ALUMINUM DISK SET IN 12" DIAMETER POURED-IN-PLACE CONCRETE MONUMENT.

RECOVERED SET BY DENI ASSOCIATES, INC., FT. MYERS, FL DATE OCTOBER 1996

HORIZONTAL VALUES ORIGINATED ON ORDER "B" IOWA HIGH ACCURACY REFERENCE NETWORK (HARN) CONTROL ESTABLISHED BY THE NATIONAL GEODETIC SURVEY AND BASED ON THE NORTH AMERICAN DATUM OF 1983, 1996 ADJUSTMENT.

IOWA COORDINATE SYSTEM, SOUTH ZONE GRID

SCALE FACTOR: 0.99995207

COORDINATES (US FEET)

COORDINATES (METERS)

NORTHING (Y) 380945.47

NORTHING (Y) 116112.413

EASTING (X) 1779147.44

EASTING (X) 542285.224

TIES

- No. 1 - 8.5'
- No. 2 - 24.7'
- No. 3 - 21.2'
- No. 4 - 23.5'
- No. 5 - 8.5'

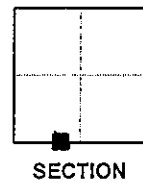
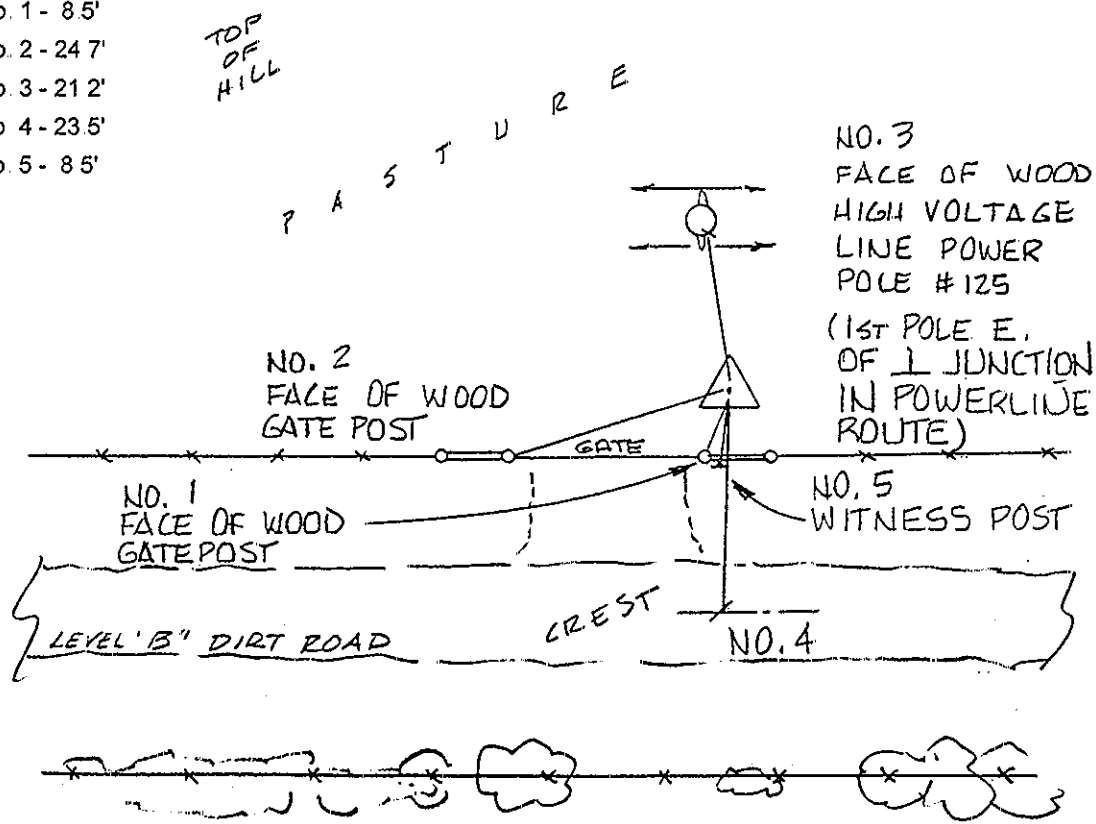

SKETCH
BY DSW
DENI 9609001