

GPS SURVEY MARK DESCRIPTION

GIS MAPPING BY:
THE SIDWELL COMPANY
WEST CHICAGO, ILLINOIS

THE OFFICE OF THE
COUNTY ENGINEER
MONROE COUNTY, IOWA

DESIGNATION 711912 3 GPS No. 6021 COUNTY MONROE STATE IOWA
 LOCATED IN SECTION 12 TWP 71 N RGE 19 W USGS QUAD MAP ICONIUM
 TO REACH FROM THE INTERSECTION OF COUNTY ROAD S70 AND COUNTY ROAD H44, SOUTH OF MELROSE;
GO EASTERLY FOR 2.85 MILES ON H44 TO DIRT (LEVEL B) ROAD EAST; THEN EASTERLY 0.5 MILE TO MARK.

TYPE OF MARK 3-1/4" ALUMINUM DISK SET IN 12" DIAMETER POURED-IN-PLACE CONCRETE MONUMENT.

RECOVERED SET BY DENI ASSOCIATES, INC., FT. MYERS, FL DATE OCTOBER 1996

HORIZONTAL VALUES ORIGINATED ON ORDER "B" IOWA HIGH ACCURACY REFERENCE NETWORK (HARN) CONTROL ESTABLISHED BY THE NATIONAL GEODETIC SURVEY AND BASED ON THE NORTH AMERICAN DATUM OF 1983, 1996 ADJUSTMENT.

IOWA COORDINATE SYSTEM, SOUTH ZONE GRID SCALE FACTOR: 0.99995742

COORDINATES (US FEET)	COORDINATES (METERS)
NORTHING (Y) <u>348866.12</u>	NORTHING (Y) <u>106334.604</u>
EASTING (X) <u>1779670.32</u>	EASTING (X) <u>542444.599</u>

TIES

- No. 1 - 26.3'
- No. 2 - 2.5'
- No. 3 - 8.4'
- No. 4 - 2.2'
- No. 5 - 23'

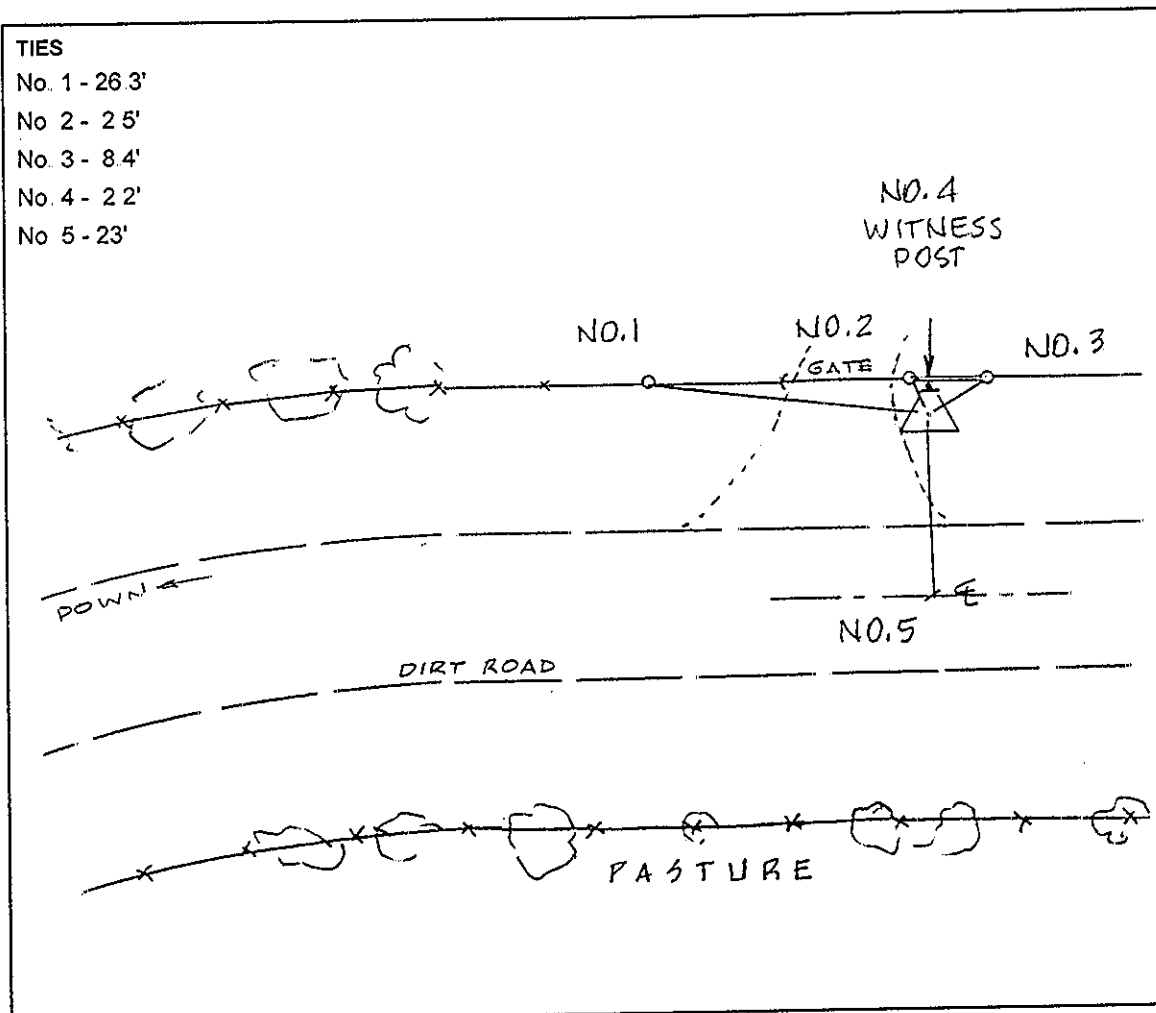
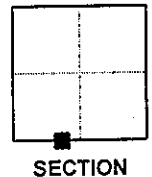

SKETCH
BY DSW
DENI 9609001