

GPS SURVEY MARK DESCRIPTION

GIS MAPPING BY:
THE SIDWELL COMPANY
WEST CHICAGO, ILLINOIS

THE OFFICE OF THE
COUNTY ENGINEER
MONROE COUNTY, IOWA

DESIGNATION 721707 2 GPS No. 6031 COUNTY MONROE STATE IOWA

LOCATED IN SECTION 7 TWP 72 N RGE 17 W USGS QUAD MAP ALBIA

TO REACH FROM THE INTERSECTION OF STATE HIGHWAY 5 AND COUNTY ROAD H32, NORTHWEST OF ALBIA;
GO WESTERLY 0.7 MILE TO A GRAVEL ROAD SW; THEN SOUTHWEST 0.25 MILE TO MARK.

TYPE OF MARK 3-1/4" ALUMINUM DISK SET IN 12" DIAMETER POURED-IN-PLACE CONCRETE MONUMENT.

RECOVERED SET BY DENI ASSOCIATES, INC., FT. MYERS, FL DATE OCTOBER 1996

HORIZONTAL VALUES ORIGINATED ON ORDER "B" IOWA HIGH ACCURACY REFERENCE NETWORK (HARN) CONTROL ESTABLISHED BY THE NATIONAL GEODETIC SURVEY AND BASED ON THE NORTH AMERICAN DATUM OF 1983, 1996 ADJUSTMENT.

IOWA COORDINATE SYSTEM, SOUTH ZONE GRID SCALE FACTOR: 0.99995204

COORDINATES (US FEET)	COORDINATES (METERS)
NORTHING (Y) <u>381424.43</u>	NORTHING (Y) <u>116258.399</u>
EASTING (X) <u>1819284.45</u>	EASTING (X) <u>554519.009</u>

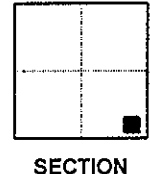
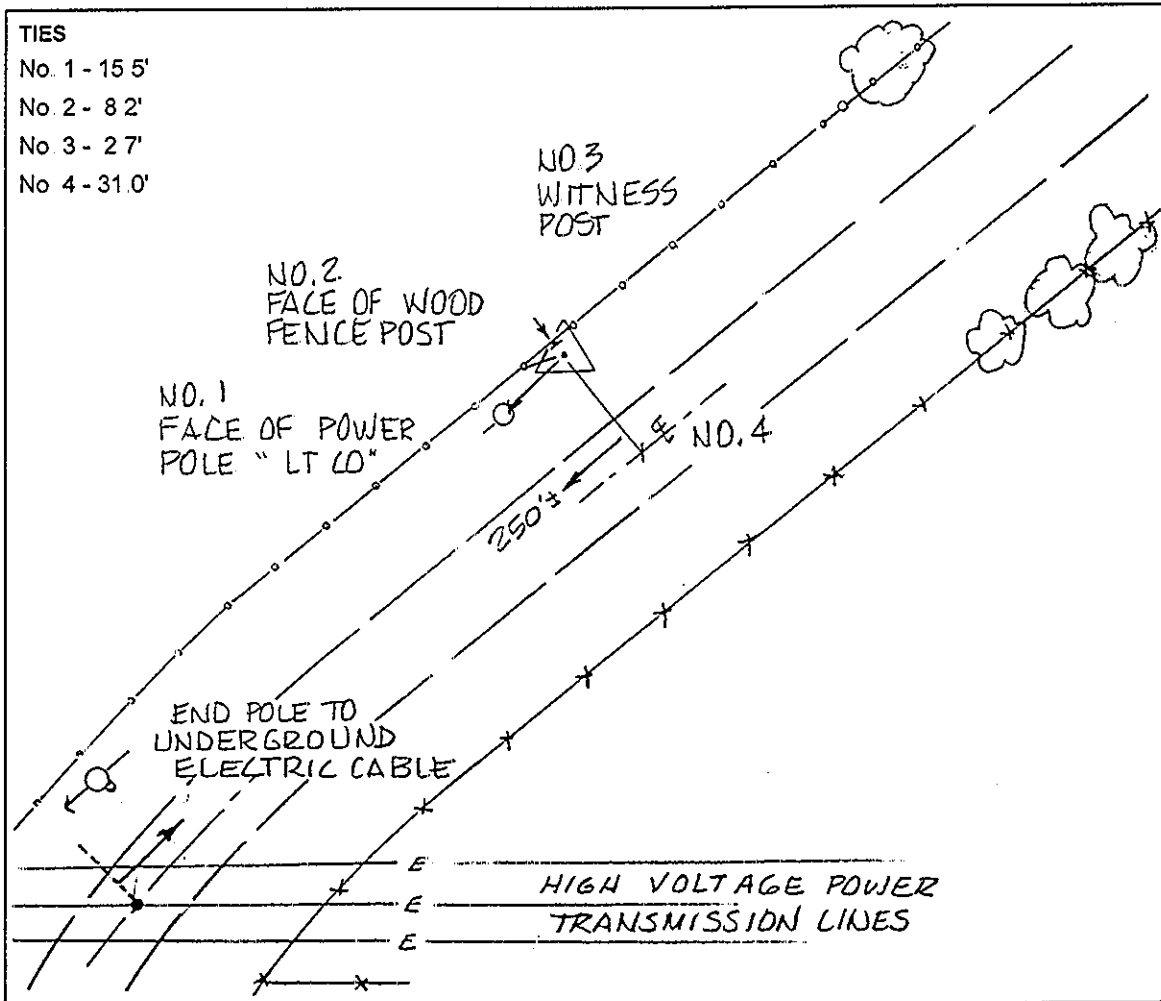

SKETCH
BY DSW
DENI 9609001