

GPS SURVEY MARK DESCRIPTION

GIS MAPPING BY:
THE SIDWELL COMPANY
WEST CHICAGO, ILLINOIS

THE OFFICE OF THE
COUNTY ENGINEER
MONROE COUNTY, IOWA

DESIGNATION 731736 3 GPS No. 6043 COUNTY MONROE STATE IOWA

LOCATED IN SECTION 36 TWP 73 N RGE 17 W USGS QUAD MAP ALBIA

TO REACH FROM THE INTERSECTION OF STATE HIGHWAY 5 AND COUNTY ROAD H27, NORTH OF ALBIA;

GO EASTERLY AND NORTHERLY FOR 2.4 MILES ON H27 TO GRAVEL ROAD NORTH; THEN NORTH 1.2 MILES TO

GRAVEL ROAD INTERSECTION; THEN EAST 0.1 MILE TO MARK, ON CREST OF HILL.

TYPE OF MARK 3-1/4" ALUMINUM DISK SET IN 12" DIAMETER POURED-IN-PLACE CONCRETE MONUMENT.

RECOVERED SET BY DENI ASSOCIATES, INC., FT. MYERS, FL DATE OCTOBER 1996

HORIZONTAL VALUES ORIGINATED ON ORDER "B" IOWA HIGH ACCURACY REFERENCE NETWORK (HARN) CONTROL ESTABLISHED BY THE NATIONAL GEODETIC SURVEY AND BASED ON THE NORTH AMERICAN DATUM OF 1983, 1996 ADJUSTMENT.

IOWA COORDINATE SYSTEM, SOUTH ZONE GRID

SCALE FACTOR: 0.99995077

COORDINATES (US FEET)

COORDINATES (METERS)

NORTHING (Y) 392473.83

NORTHING (Y) 119626.264

EASTING (X) 1842509.77

EASTING (X) 561598.102

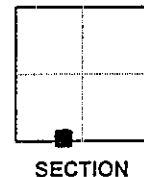
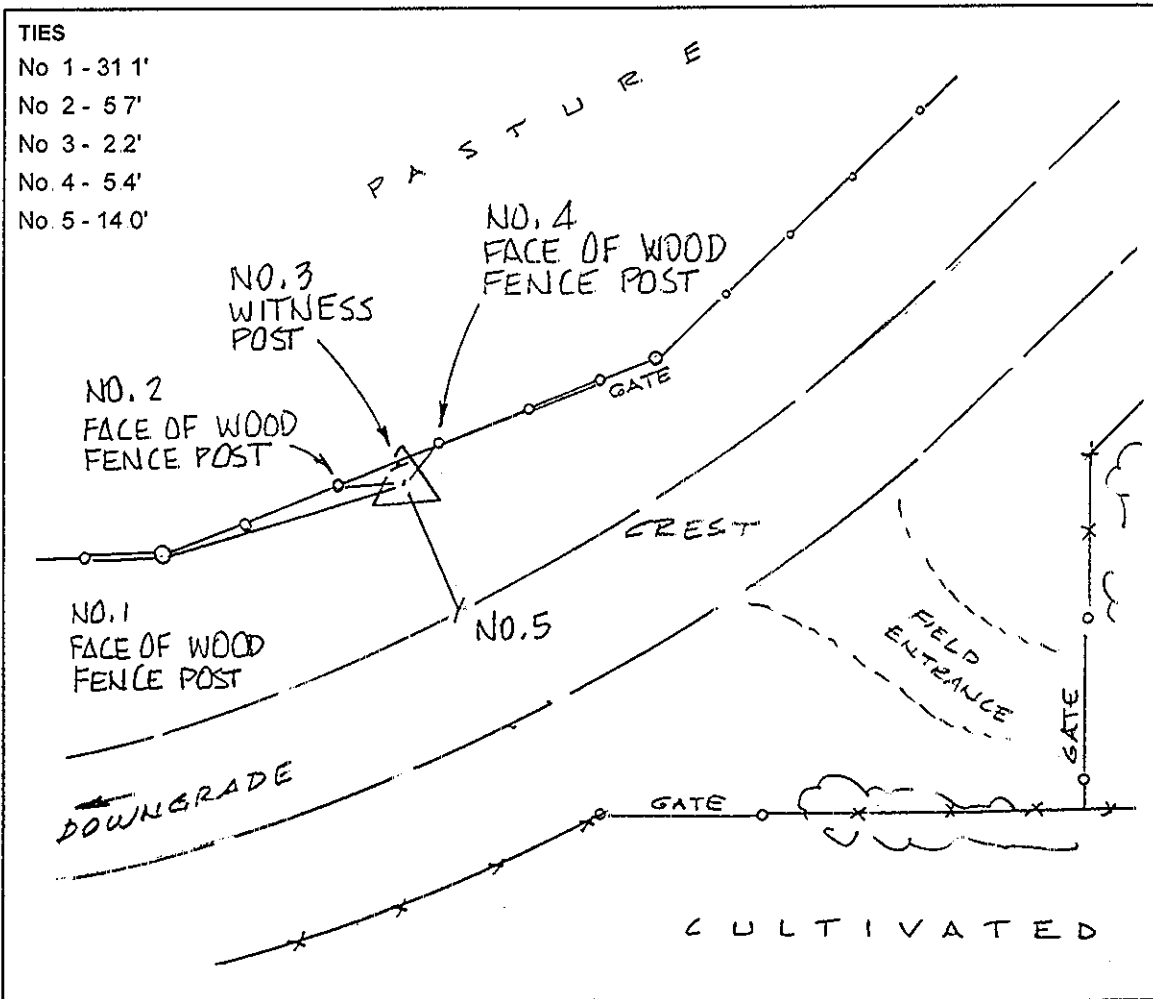

SKETCH
BY DSW
DENI 9609001