

# GPS SURVEY MARK DESCRIPTION

GIS MAPPING BY:  
THE SIDWELL COMPANY  
WEST CHICAGO, ILLINOIS

THE OFFICE OF THE  
COUNTY ENGINEER  
MONROE COUNTY, IOWA

DESIGNATION GEORGETOWN GPS No. 9668 COUNTY MONROE STATE IOWA

LOCATED IN SECTION 29 TWP 72 N RGE 18 W USGS QUAD MAP HITEMAN

TO REACH FROM THE INTERSECTION OF U.S. HIGHWAY 34 AND COUNTY ROAD T19, AT GEORGETOWN; GO  
NORTHERLY 350 FEET, MORE OR LESS, ON T19 TO OLD HIGHWAY; THEN EASTERLY 200 FEET TO DRIVE NORTH;  
THEN NORTH 100 FEET, MORE OR LESS, TO THE MARK, IN THE FRONT LAWN OF THE CHURCH.

DISK IS STAMPED "GEORGETOWN 1956"

TYPE OF MARK STANDARD USC&GS BRONZE DISK IN 12" DIAMETER CONCRETE MONUMENT, SET FLUSH.

RECOVERED  SET BY DENI ASSOCIATES, INC., FT. MYERS, FL DATE OCTOBER 1996

HORIZONTAL VALUES ORIGINATED ON ORDER "B" IOWA HIGH ACCURACY REFERENCE NETWORK (HARN) CONTROL ESTABLISHED BY THE NATIONAL GEODETIC SURVEY AND BASED ON THE NORTH AMERICAN DATUM OF 1983, 1996 ADJUSTMENT.

IOWA COORDINATE SYSTEM, SOUTH ZONE GRID

SCALE FACTOR: 0.99995371

COORDINATES (US FEET)

COORDINATES (METERS)

NORTHING (Y) 369601.83

NORTHING (Y) 112654.863

EASTING (X) 1790683.80

EASTING (X) 545801.513

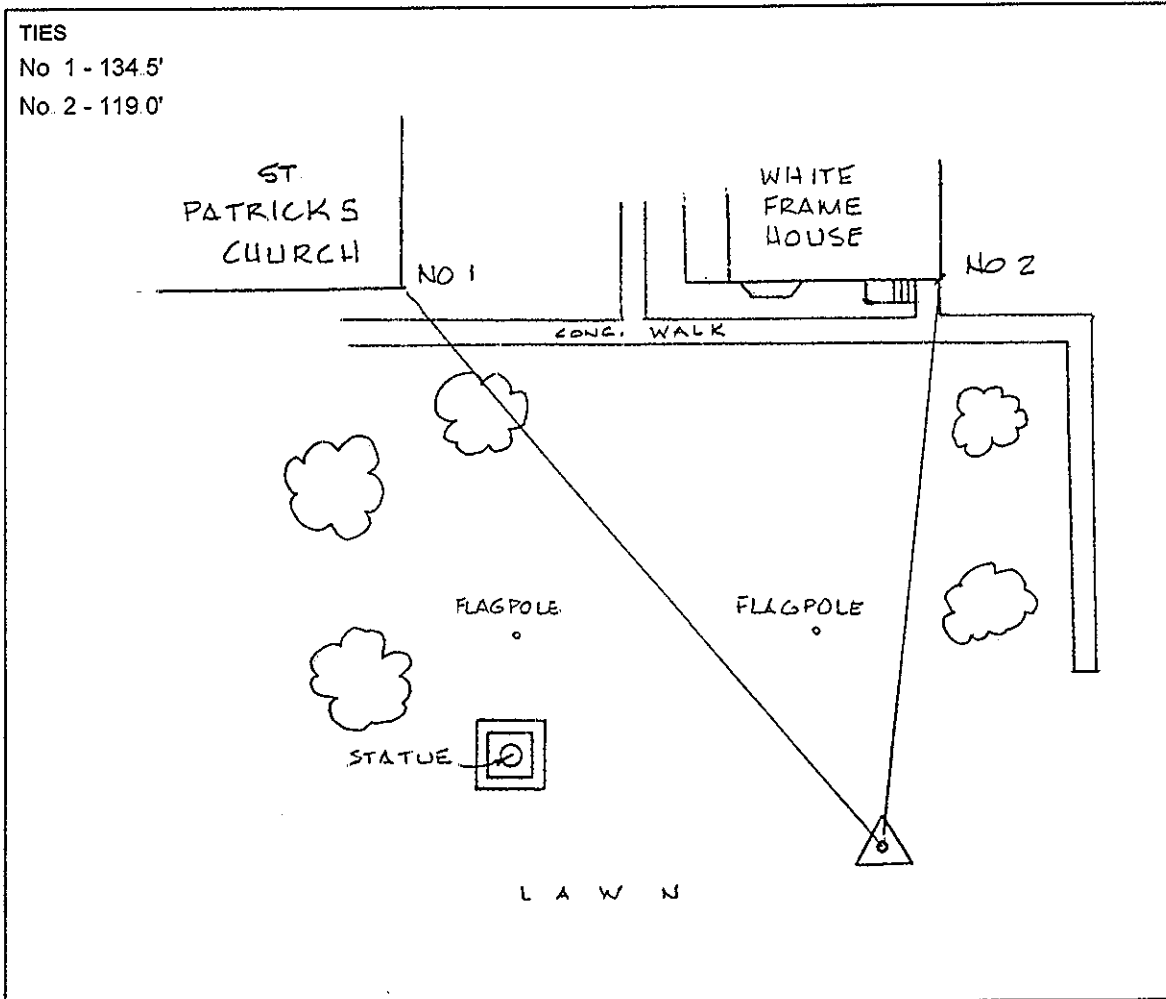

SKETCH  
BY DSW  
DENI 9609001