

GPS SURVEY MARK DESCRIPTION

GIS MAPPING BY:
THE SIDWELL COMPANY
WEST CHICAGO, ILLINOIS

THE OFFICE OF THE
COUNTY ENGINEER
MONROE COUNTY, IOWA

DESIGNATION F 111 GPS No. 9671 COUNTY MONROE STATE IOWA

LOCATED IN SECTION 4 TWP 71 N RGE 19 W USGS QUAD MAP MELROSE

TO REACH FROM THE INTERSECTION OF ERIN AVENUE AND TRALEE STREET, IN MELROSE, 200 FEET, MORE OR LESS, NORTH OF THE RAILROAD CROSSING; GO WEST ON ERIN STREET 0.25 MILE TO THE "T" INTERSECTION (TO NORTH) OF KERRY STREET; FOLLOW TRAIL SOUTH 300 FEET TO RAILROAD TRACKS; MARK IS 80 FEET EAST OF CENTERLINE TRAIL ON NORTH SIDE OF DOUBLE TRACKS. DISK IS STAMPED "F 111 1935"

TYPE OF MARK STANDARD USC&GS BRONZE DISK DRILLED INTO TOP OF CONCRETE BOX CULVERT.

RECOVERED SET BY DENI ASSOCIATES, INC., FT. MYERS, FL DATE OCTOBER 1996

HORIZONTAL VALUES ORIGINATED ON ORDER "B" IOWA HIGH ACCURACY REFERENCE NETWORK (HARN) CONTROL ESTABLISHED BY THE NATIONAL GEODETIC SURVEY AND BASED ON THE NORTH AMERICAN DATUM OF 1983, 1996 ADJUSTMENT.

IOWA COORDINATE SYSTEM, SOUTH ZONE GRID SCALE FACTOR: 0.99995615

COORDINATES (US FEET)	COORDINATES (METERS)
NORTHING (Y) <u>355245.56</u>	NORTHING (Y) <u>108279.063</u>
EASTING (X) <u>1763592.94</u>	EASTING (X) <u>537544.205</u>

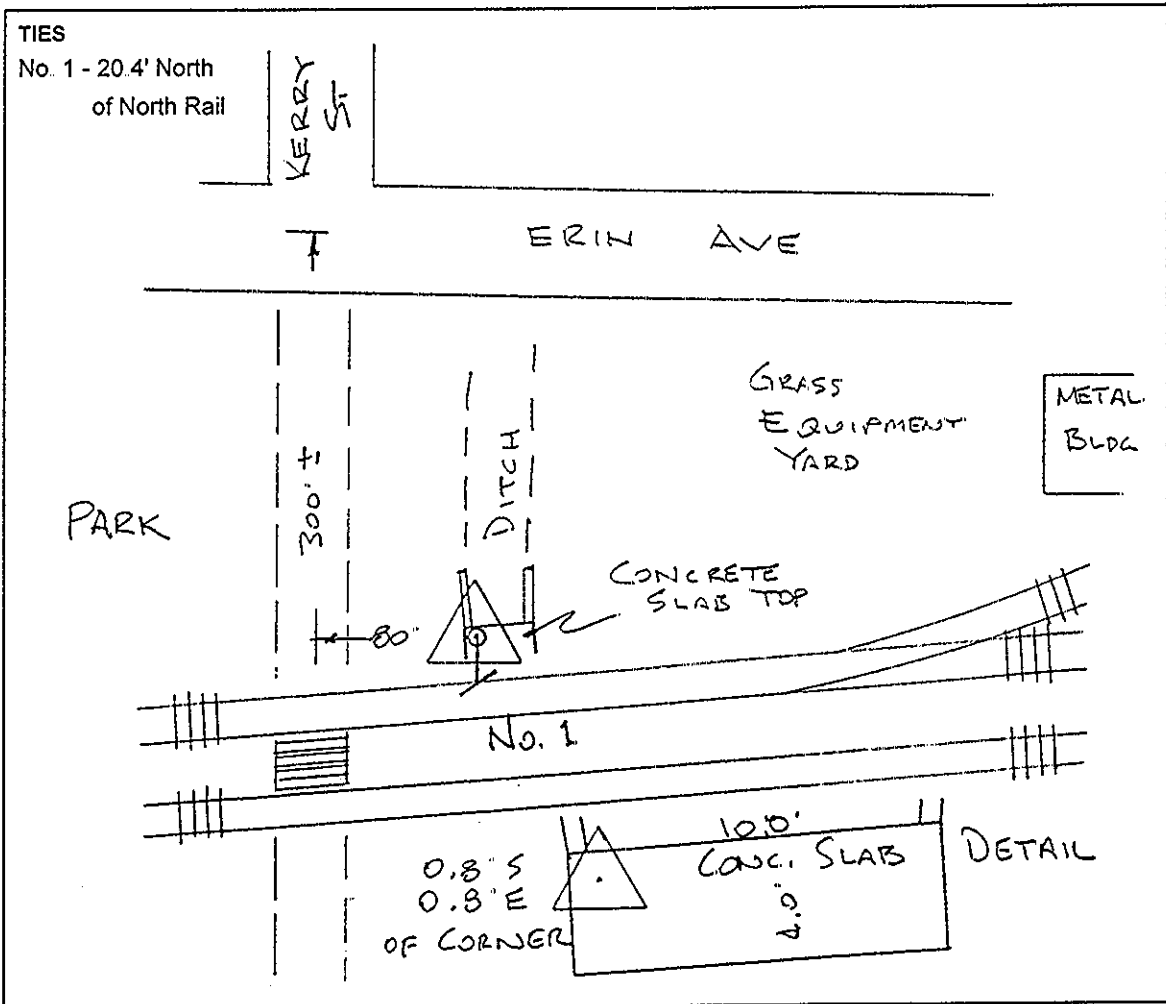

SECTION



SKETCH BY DSW

DENI 9609001