

2000
Muscatine County, Iowa
Iowa South Zone (1402)
NAD_83(1996)

Point Number: 118

Northing: 542833.82(Ft) Easting: 2296121.37(Ft)

Northing: 165456.080(M) Easting: 699859.195(M)

Elev: 711.29(Ft) NAVD_88

Elev: 216.801(M) NAVD_88 Ellip Ht: 184.065(M) 96C Geoid Ht: -32.737(M)

Latitude: 41-27-54.622714 N Longitude: 91-06-26.093712 W

Theta: 1-34-33.99 Combination Factor: 0.99993010

Designation: MUSCATINE CO GPS CONTROL PT 2000-118

Monument Type: 5/8" dia driven aluminum rod with a 2-1/2" dia aluminum cap and permanent magnet encased in a 5" dia PVC pipe with an aluminum access cover.

To Reach: 25ft S of Bayfield Rd., approx. 330ft W of Lindle Ave. near the S 1/4 cor Sec 17 T77N R2W.

Date Printed August 9, 2000



Set NGS style
rod monument
with access cover

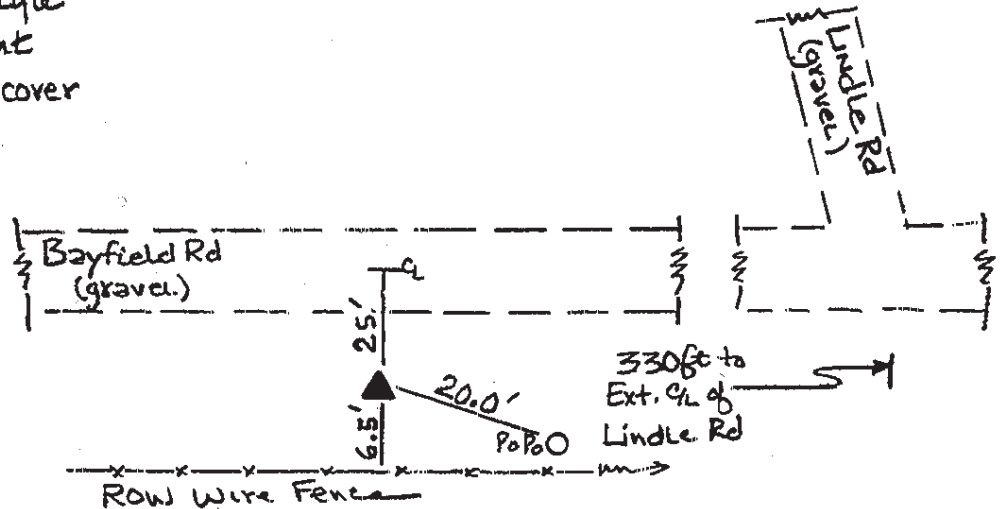

118
BRS/RKE
APRIL 2000