

2000  
Muscatine County, Iowa  
Iowa South Zone (1402)  
NAD\_83(1996)

Point Number: 132

Northing: 528931.47(Ft)      Easting: 2323663.82(Ft)

Northing: 161218.634(M)      Easting: 708254.148(M)

Elev: 558.53(Ft) NAVD\_88

Elev: 170.241(M) NAVD\_88      Ellip Ht: 137.462(M)      96C Geoid Ht: -32.780(M)

Latitude: 41-25-29.678058 N      Longitude: 91-00-29.696690 W

Theta: 1-38-28.75      Combination Factor: 0.99993442

Designation: MUSCATINE CO GPS CONTROL PT 2000-132

**Monument Type:** 5/8" dia driven aluminum rod with a 2-1/2" dia aluminum cap and permanent magnet encased in a 5" dia PVC pipe with an aluminum access cover.

**To Reach:** 25ft N of 102nd Av W (in Illinois), 20ft E of E most entr to Lock #16 in the SE 1/4 of Sec 31 T 77N R1W.

Date Printed August 9, 2000

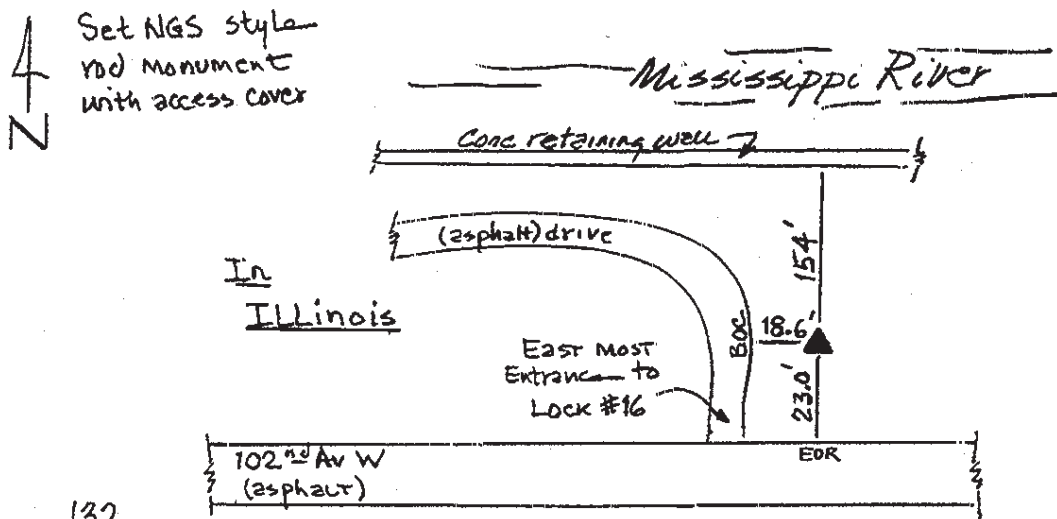

132  
BRS/RKE  
APRIL 2000