

2000  
Muscatine County, Iowa  
Iowa South Zone (1402)  
NAD\_83(1996)

Point Number: 137

Northing: 510768.26(Ft)      Easting: 2283087.79(Ft)

Northing: 155682.479(M)      Easting: 695886.551(M)

Elev: 535.19(Ft) NAVD\_88

Elev: 163.127(M) NAVD\_88      Ellip Ht: 130.295(M)      96C Geoid Ht: -32.832(M)

Latitude: 41-22-41.425999 N      Longitude: 91-09-28.569879 W

Theta: 1-32-33.79      Combination Factor: 0.99993270

Designation: MUSCATINE CO GPS CONTROL PT 2000-137

**Monument Type:** 5/8" dia driven aluminum rod with a 2-1/2" dia aluminum cap and permanent magnet encased in a 5" dia PVC pipe with an aluminum access cover.

**To Reach:** 25ft S of 41st St, 0.3 mi W of Melon Av, near the N/S section line, near the NE cor Sec 23 T76N R3W.

Date Printed August 9, 2000

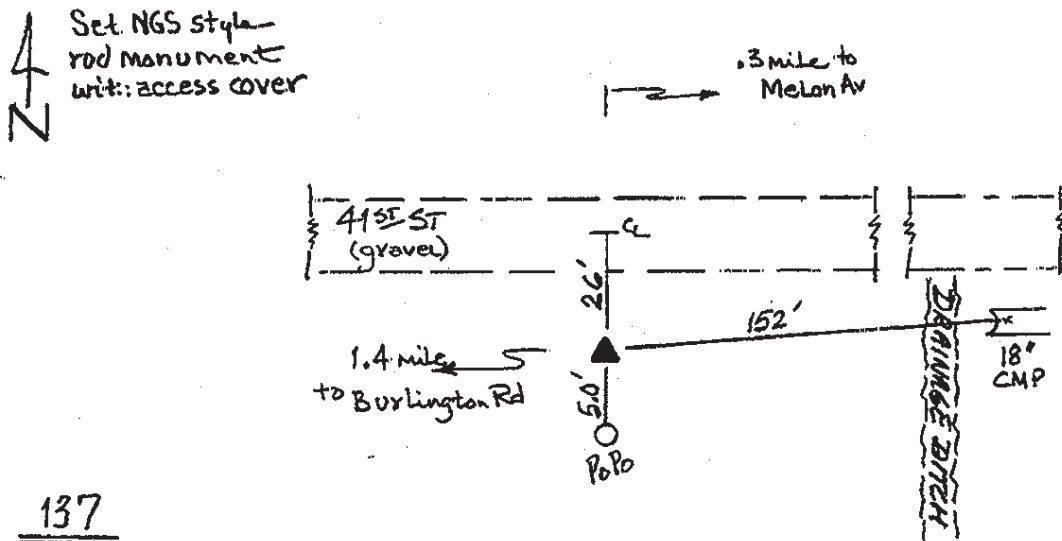

137  
BRS/RKE  
APRIL 2000