

2000  
Muscatine County, Iowa  
Iowa South Zone (1402)  
NAD\_83(1996)

Point Number: 142

Northing: 505865.92(Ft)      Easting: 2306755.02(Ft)

Northing: 154188.242(M)      Easting: 703100.335(M)

Elev: 541.59(Ft) NAVD\_88

Elev: 165.078(M) NAVD\_88      Ellip Ht: 132.234(M)      96C Geoid Ht: -32.844(M)

Latitude: 41-21-46.596087 N      Longitude: 91-04-20.024222 W

Theta: 1-35-57.03      Combination Factor: 0.99993161

Designation: MUSCATINE CO GPS CONTROL PT 2000-142

**Monument Type:** 5/8" dia driven aluminum rod with a 2-1/2" dia aluminum cap and permanent magnet encased in a 5" dia PVC pipe with an aluminum access cover.

**To Reach:** Approx. 0.2 mi E of Pettibone, in a grassy field area approx. 110ft WSW of a power pole on line with extended CL of 57th St S to W near S 1/4 cor of Sec 22 T76N R2W.

Date Printed August 9, 2000

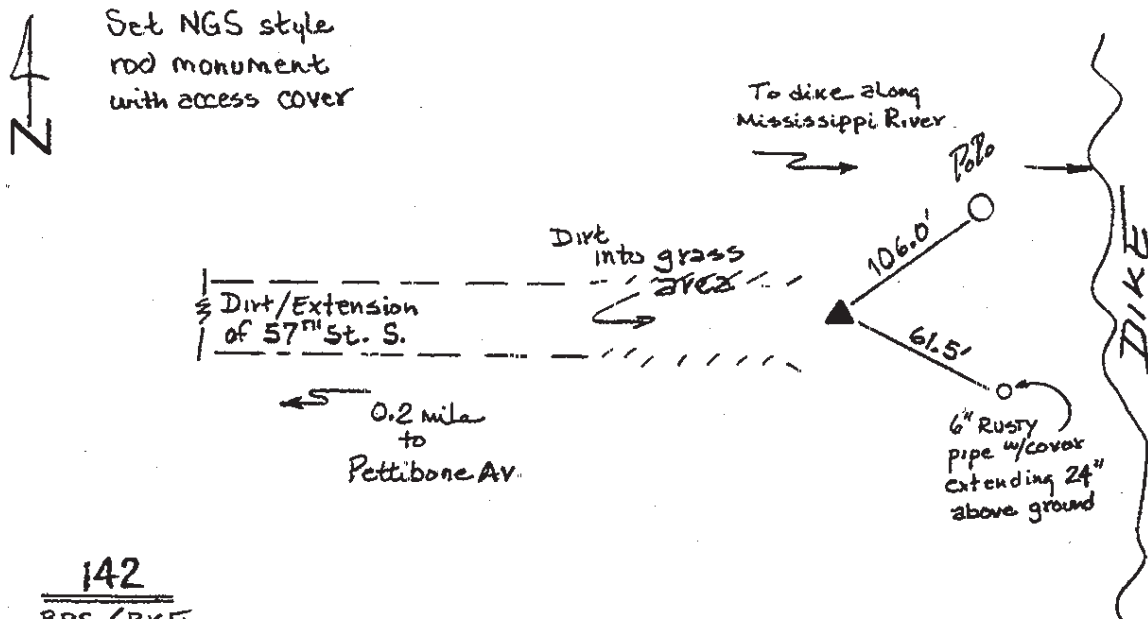

142  
BRS/RKE  
APRIL 2000