

2000
Muscatine County, Iowa
Iowa South Zone (1402)
NAD_83(1996)

Point Number: 311

Northing: 533158.59(Ft) Easting: 2321426.85(Ft)

Northing: 162507.064(M) Easting: 707572.318(M)

Elev: 552.71(Ft) NAVD_88

Elev: 168.466(M) NAVD_88 Ellip Ht: 135.696(M) 96C Geoid Ht: -32.771(M)

Latitude: 41-26-12.058386 N Longitude: 91-00-57.465238 W

Theta: 1-38-10.46 Combination Factor: 0.99993552

Designation: CITY OF MUSCATINE GPS CONTROL PT 2000-311

Monument Type: 5/8" dia driven aluminum rod with a 2-1/2" dia aluminum cap and permanent magnet encased in a 5" dia PVC pipe with an aluminum access cover.

To Reach: 50ft N of R.R., 100ft W of paved bike trail to N, 10ft S of paved bike trail to W in the SW 1/4 of Sec 30 T77N R1W.

Date Printed August 9, 2000

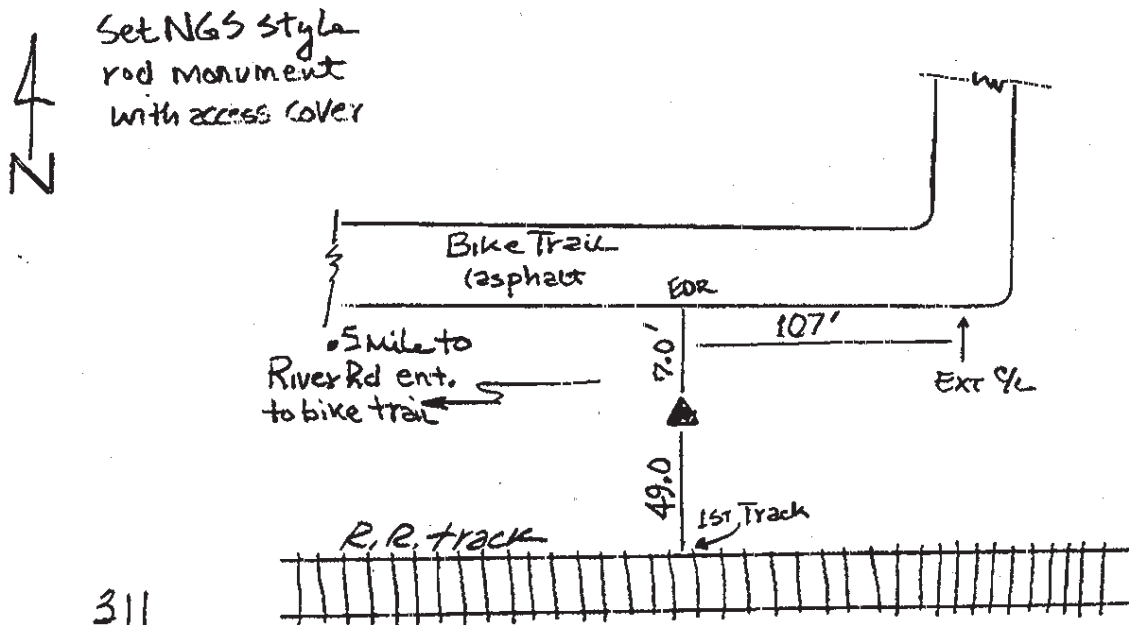

311
BRS/RKE
APRIL 2000