

2000  
Muscatine County, Iowa  
Iowa South Zone (1402)  
NAD\_83(1996)

Point Number: 318

Northing: 521907.15(Ft)      Easting: 2305573.76(Ft)

Northing: 159077.618(M)      Easting: 702740.289(M)

Elev: 539.25(Ft) NAVD\_88

Elev: 164.365(M) NAVD\_88      Ellip Ht: 131.558(M)      96C Geoid Ht: -32.807(M)

Latitude: 41-24-25.354073 N      Longitude: 91-04-29.645413 W

Theta: 1-35-50.69      Combination Factor: 0.99993418

Designation: CITY OF MUSCATINE GPS CONTROL PT 2000-318

**Monument Type:** 5/8" dia driven aluminum rod with a 2-1/2" dia aluminum cap and permanent magnet encased in a 5" dia PVC pipe with an aluminum access cover.

**To Reach:** 20ft S of Musser St., approx. 0.25 mi E of Houser St, on line with W edge of W entr to Sewage Diposal Plant in the SW 1/4 of Sec 3 T76N R2W.

Date Printed August 9, 2000

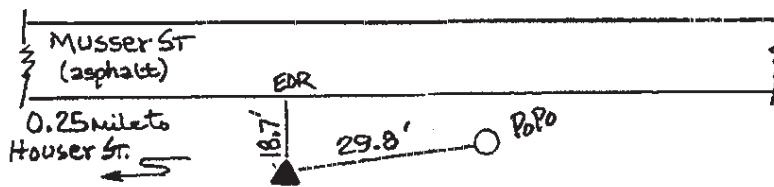
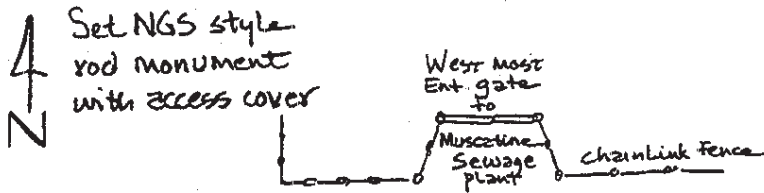

318  
BRS/RXE  
APRIL 2000

