

2000
Muscatine County, Iowa
Iowa South Zone (1402)
NAD_83(1996)

Point Number: 400

Northing: 578595.74(Ft) Easting: 2224430.17(Ft)

Northing: 176356.335(M) Easting: 678007.673(M)

Elev: 714.34(Ft) NAVD_88

Elev: 217.731(M) NAVD_88 Ellip Ht: 185.151(M) 96C Geoid Ht: -32.581(M)

Latitude: 41-34-06.265488 N Longitude: 91-21-55.964971 W

Theta: 1-24-21.48 Combination Factor: 0.99993985



Designation: **PHOTOGRAMMETRIC SURVEY MARKER**

Monument Type: 5/8" x 30" deformed rebar with red plastic survey cap.

To Reach: 25ft N of SE 500th St. (Johnson Co.), approximately 320ft E of SE Johnson-Muscatine Rd, near the SW cor Sec 7 T78N R4W.

Date Printed August 9, 2000

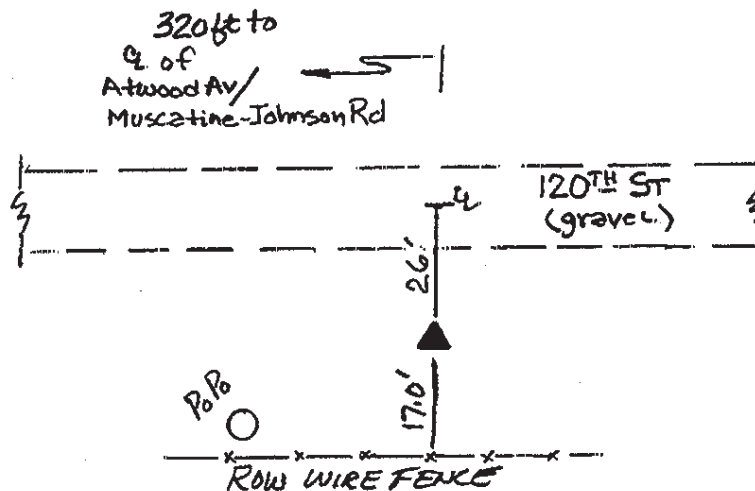
Set 5/8" rebar
with red cap



400
BRS/RKE
APRIL 2000