

**Muscatine County, Iowa**

Horizontal Datum: **NAD 83(2011)** - Vertical Datum: **NAVD 1988**  
Iowa State Plane South Zone (1402)  
Iowa Regional Coordinate System Zone 14 Burlington  
US Survey Feet  
**2014**

Point Name: **118**

**Designation:** Muscatine Co. GPS Control Pt 2000-118 (Set by ASI in 2000)

NAD 83(NA2011) Latitude: **N41°27'54.62268"** Longitude: **W91°06'26.09255"**  
NAVD 88 Ortho Height: **711.290sft** Ellip. Ht: **603.499sft** **Geoid12A**

Iowa South Zone (1402) Northing: **542833.821sft** Easting: **2296121.463sft**  
Mapping Angle: **1°34'34"** Combination Scale Factor: **0.999930186**

IaRCS Zone 14 Northing: **6642776.796sft** Easting: **24539126.729sft**  
Mapping Angle: **0°05'40"** Combination Scale Factor: **0.9999909519**

**Monument Type:** 5/8" dia. driven aluminum rod with a 2-1/2" dia. aluminum cap and permanent magnet encased in a 5" dia. PVC pipe with an aluminum access cover.



Set NGS style  
rod monument  
with access cover

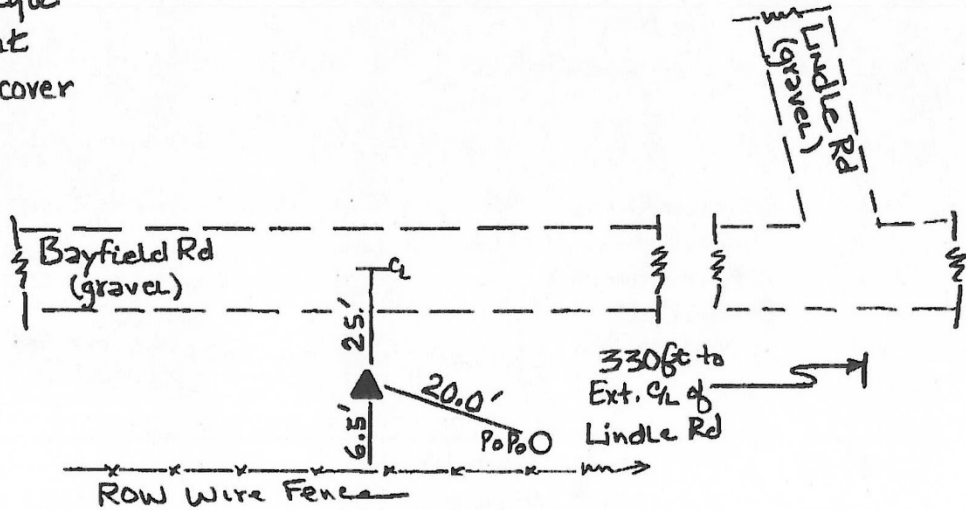

118  
BRS/RKE  
APRIL 2000