

Muscatine County, Iowa

Horizontal Datum: **NAD 83(2011)** - Vertical Datum: **NAVD 1988**

Iowa State Plane South Zone (1402)

Iowa Regional Coordinate System Zone 14 Burlington

US Survey Feet

2014

Point Name: **123**

Designation: Muscatine Co. GPS Control Pt 2000-123 (Set by ASI in 2000)

NAD 83(NA2011) Latitude: **N41°26'38.28879"** Longitude: **W90°59'21.38941"**

NAVD 88 Ortho Height: **556.920sft** Ellip. Ht: **449.047sft** **Geoid12A**

Iowa South Zone (1402) Northing: **536022.373sft** Easting: **2328664.770sft**

Mapping Angle: **1°39'14"** Combination Scale Factor: **0.999935920**

laRCS Zone 14 Northing: **6635125.811sft** Easting: **24571485.117sft**

Mapping Angle: **0°10'21"** Combination Scale Factor: **1.0000024121**

Monument Type: 5/8" dia. driven aluminum rod with a 2-1/2" dia. aluminum cap and permanent magnet encased in a 5" dia. PVC pipe with an aluminum access cover.

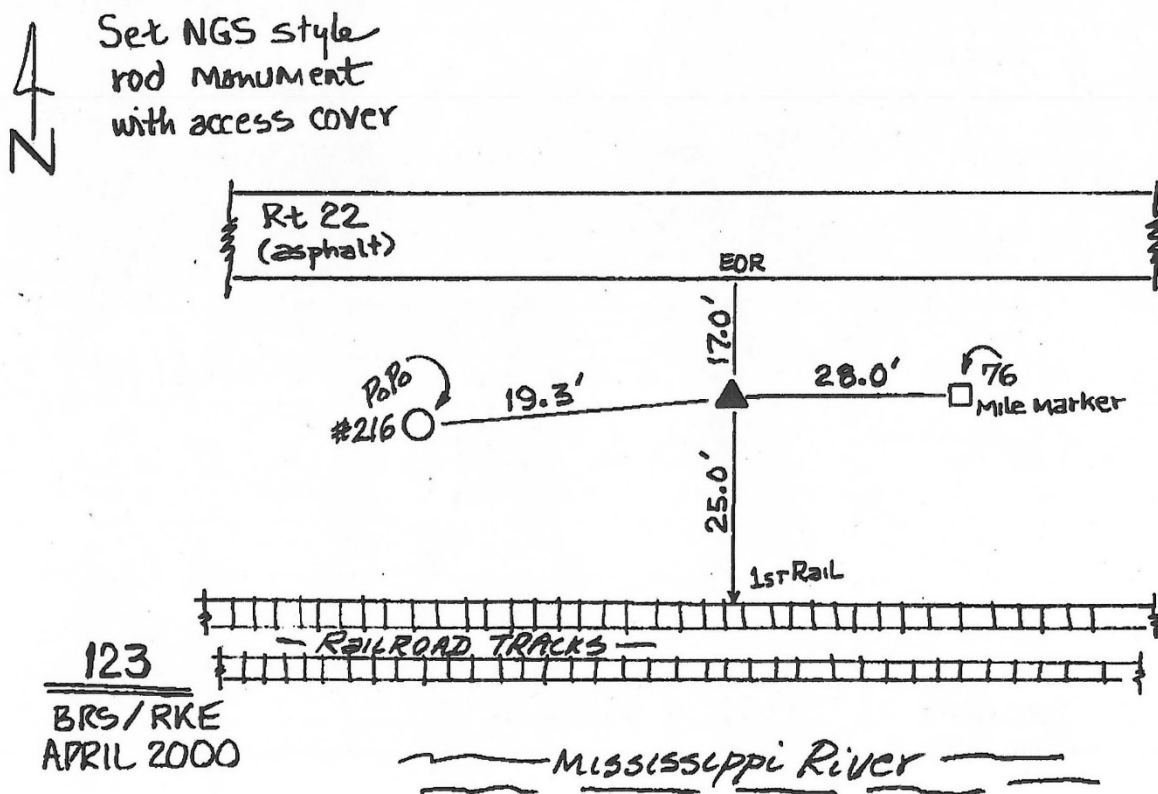

This document was prepared by DCI on November 10, 2014 for use by Muscatine County, Iowa