

Muscatine County, Iowa

Horizontal Datum: **NAD 83(2011)** - Vertical Datum: **NAVD 1988**

Iowa State Plane South Zone (1402)

Iowa Regional Coordinate System Zone 14 Burlington

US Survey Feet

2014

Point Name: **145**

Designation: Muscatine Co. GPS Control Pt 2000-145 (Set by ASI in 2000)

NAD 83(NA2011) Latitude: **N41°20'56.30089"** Longitude: **W91°08'18.05963"**

NAVD 88 Ortho Height: **546.080sft** Ellip. Ht: **437.932sft** **Geoid12A**

Iowa South Zone (1402) Northing: **500277.817sft** Easting: **2288749.837sft**

Mapping Angle: **1°33'20"** Combination Scale Factor: **0.999930804**

IaRCS Zone 14 Northing: **6600422.911sft** Easting: **24530656.601sft**

Mapping Angle: **0°04'26"** Combination Scale Factor: **0.9999981766**

Monument Type: 5/8" dia. driven aluminum rod with a 2-1/2" dia. aluminum cap and permanent magnet encased in a 5" dia. PVC pipe with an aluminum access cover.

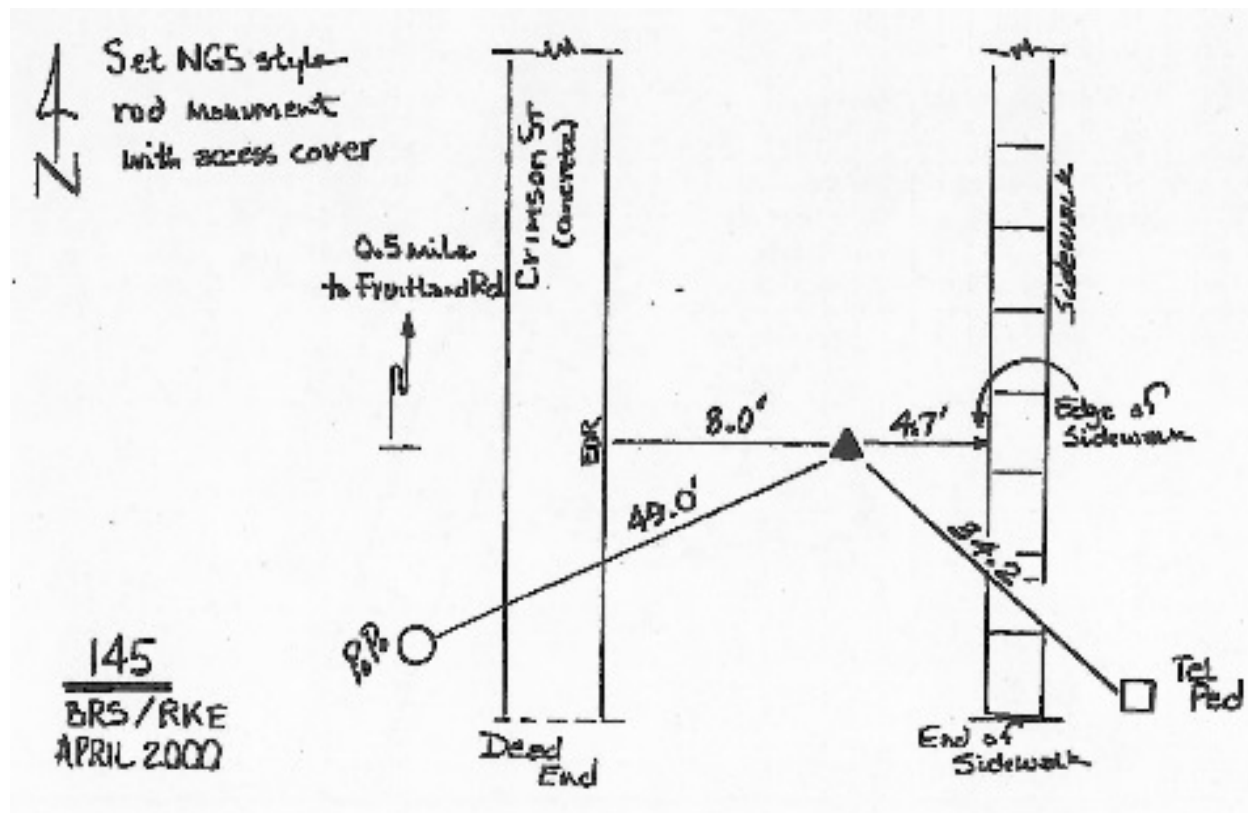

This document was prepared by DCI on November 10, 2014 for use by Muscatine County, Iowa