

Muscatine County, Iowa

Horizontal Datum: **NAD 83(2011)** - Vertical Datum: **NAVD 1988**

Iowa State Plane South Zone (1402)

Iowa Regional Coordinate System Zone 14 Burlington

US Survey Feet

2014

Point Name: **311**

Designation: City of Muscatine GPS Control Pt 2000-311 (Set by ASI in 2000)

NAD 83(NA2011) Latitude: **N41°26'12.05858"** Longitude: **W91°00'57.46465"**

NAVD 88 Ortho Height: **552.710sft** Ellip. Ht: **444.800sft** **Geoid12A**

Iowa South Zone (1402) Northing: **533158.613sft** Easting: **2321426.892sft**

Mapping Angle: **1°38'10"** Combination Scale Factor: **0.999935593**

IaRCS Zone 14 Northing: **6632449.935sft** Easting: **24564175.145sft**

Mapping Angle: **0°09'18"** Combination Scale Factor: **1.0000014815**

Monument Type: 5/8" dia. driven aluminum rod with a 2-1/2" dia. aluminum cap and permanent magnet encased in a 5" dia. PVC pipe with an aluminum access cover.

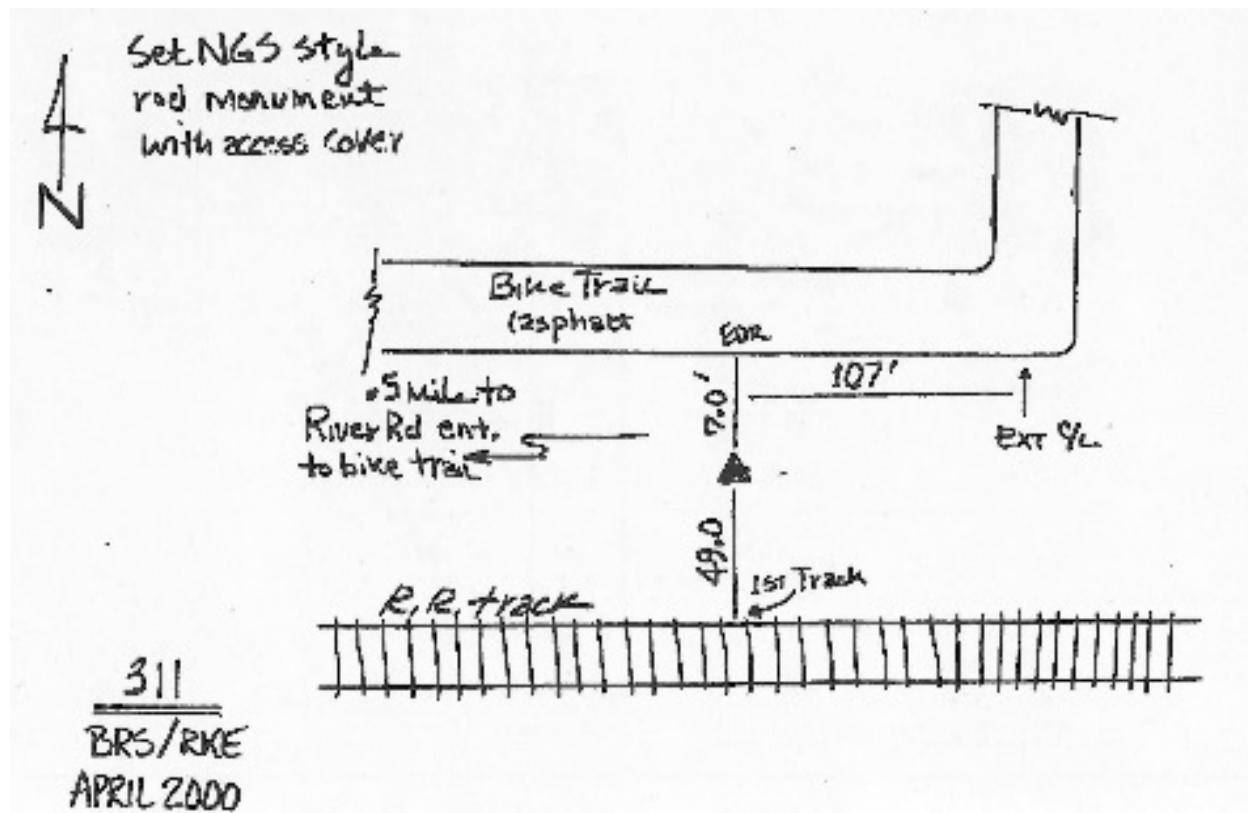

This document was prepared by DCI on November 10, 2014 for use by Muscatine County, Iowa