

Muscatine County, Iowa

Horizontal Datum: **NAD 83(2011)** - Vertical Datum: **NAVD 1988**
Iowa State Plane South Zone (1402)
Iowa Regional Coordinate System Zone 14 Burlington
US Survey Feet
2014

Point Name: **319**

Designation: City of Muscatine GPS Control Pt 2000-319 (Set by ASI in 2000)

NAD 83(NA2011) Latitude: **N41°24'21.43637"** Longitude: **W91°03'42.53930"**
NAVD 88 Ortho Height: **543.538sft** Ellip. Ht: **435.526sft** **Geoid12A**

Iowa South Zone (1402) Northing: **521611.125sft** Easting: **2309172.909sft**
Mapping Angle: **1°36'22"** Combination Scale Factor: **0.999933976**

IaRCS Zone 14 Northing: **6621222.374sft** Easting: **24551625.884sft**
Mapping Angle: **0°07'28"** Combination Scale Factor: **1.0000002633**

Monument Type: 5/8" dia. driven aluminum rod with a 2-1/2" dia. aluminum cap and permanent magnet encased in a 5" dia. PVC pipe with an aluminum access cover.

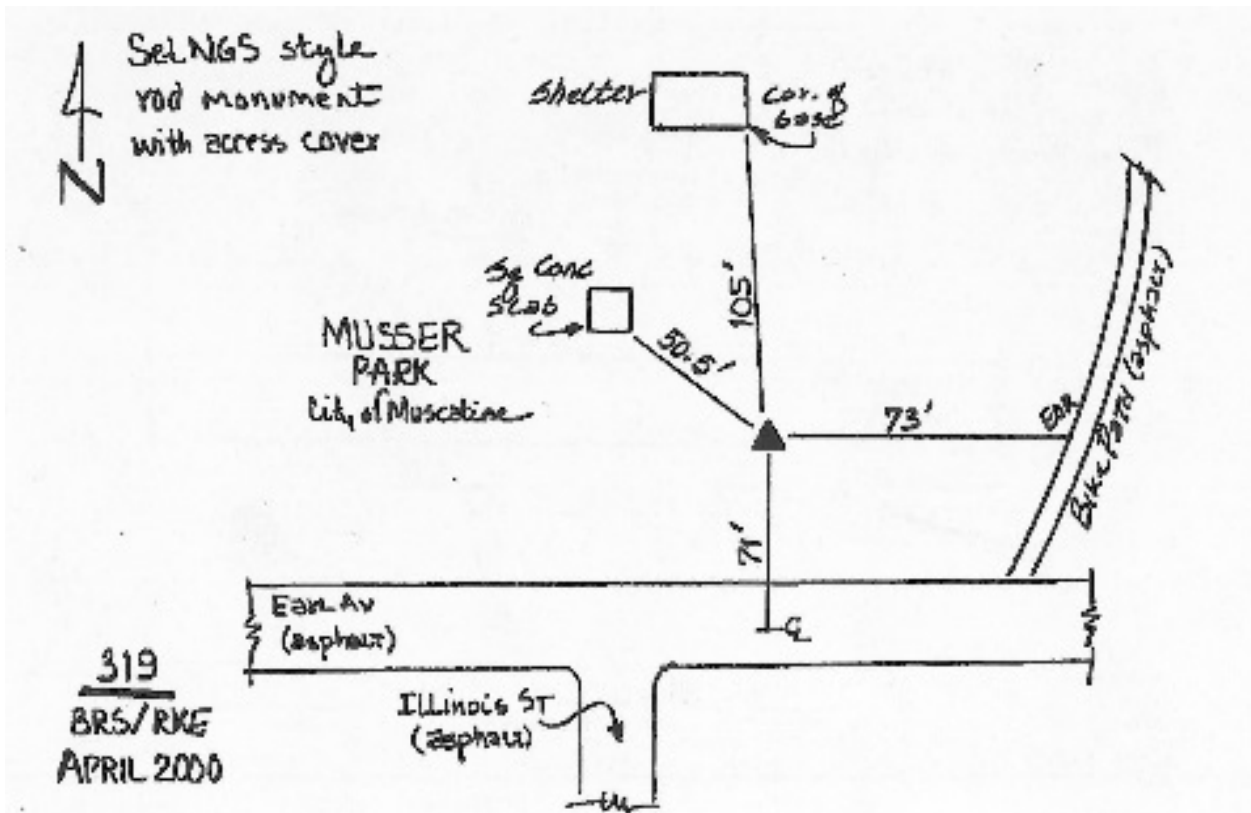

This document was prepared by DCI on November 10, 2014 for use by Muscatine County, Iowa