

**Muscatine County, Iowa**

Horizontal Datum: **NAD 83(2011)** - Vertical Datum: **NAVD 1988**  
Iowa State Plane South Zone (1402)  
Iowa Regional Coordinate System Zone 14 Burlington  
US Survey Feet  
**2014**

Point Name: **321**

**Designation:** City of Muscatine GPS Control Pt 2000-321 (Set by ASI in 2000)

NAD 83(NA2011) Latitude: **N41°23'32.00453"** Longitude: **W91°04'22.21809"**  
NAVD 88 Ortho Height: **543.750sft** Ellip. Ht: **435.693sft** **Geoid12A**

Iowa South Zone (1402) Northing: **516525.499sft** Easting: **2306290.147sft**  
Mapping Angle: **1°35'56"** Combination Scale Factor: **0.999933141**

IaRCS Zone 14 Northing: **6616212.652sft** Easting: **24548612.392sft**  
Mapping Angle: **0°07'02"** Combination Scale Factor: **0.9999999101**

**Monument Type:** 5/8" dia. driven aluminum rod with a 2-1/2" dia. aluminum cap and permanent magnet encased in a 5" dia. PVC pipe with an aluminum access cover.

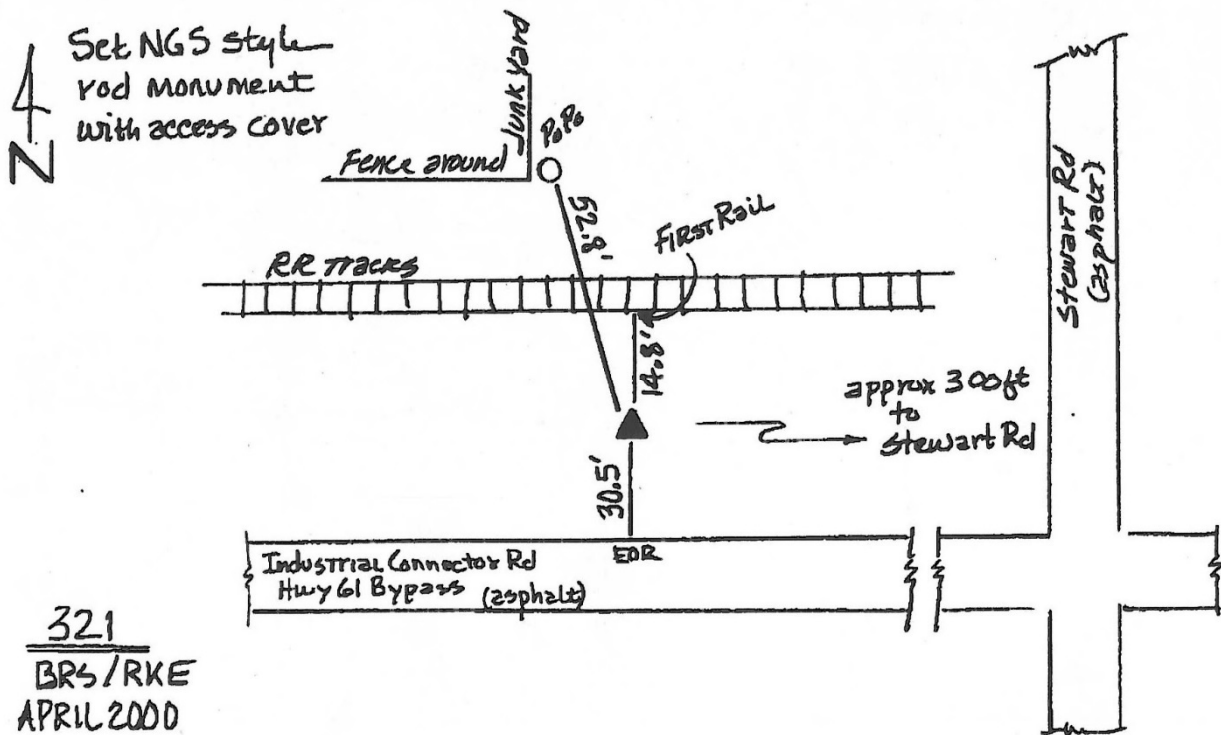

*This document was prepared by DCI on November 10, 2014 for use by Muscatine County, Iowa*