

Muscatine County, Iowa

Horizontal Datum: **NAD 83(2011)** - Vertical Datum: **NAVD 1988**

Iowa State Plane South Zone (1402)

Iowa Regional Coordinate System Zone 14 Burlington

US Survey Feet

2014

Point Name: **327 (Destroyed)**

Designation: City of Muscatine GPS Control Pt 2000-327 (Set by ASI in 2000)

NAD 83(NA2011) Latitude: **N41°21'48.688878"** Longitude: **W91°09'19.666371"**

NAVD 88 Ortho Height: **540.08sft** Ellip. Ht: **432.32sft** **Geoid96C**

Iowa South Zone (1402) Northing: **505450.97sft** Easting: **2283910.13sft**

Mapping Angle: **1°32'40"** Combination Scale Factor: **0.99993174**

laRCS Zone 14 Northing: **N/Asft** Easting: **N/Asft**

Mapping Angle: **N/A** Combination Scale Factor: **N/A**

Monument Type: 5/8" dia. driven aluminum rod with a 2-1/2" dia. aluminum cap and permanent magnet encased in a 5" dia. PVC pipe with an aluminum access cover.

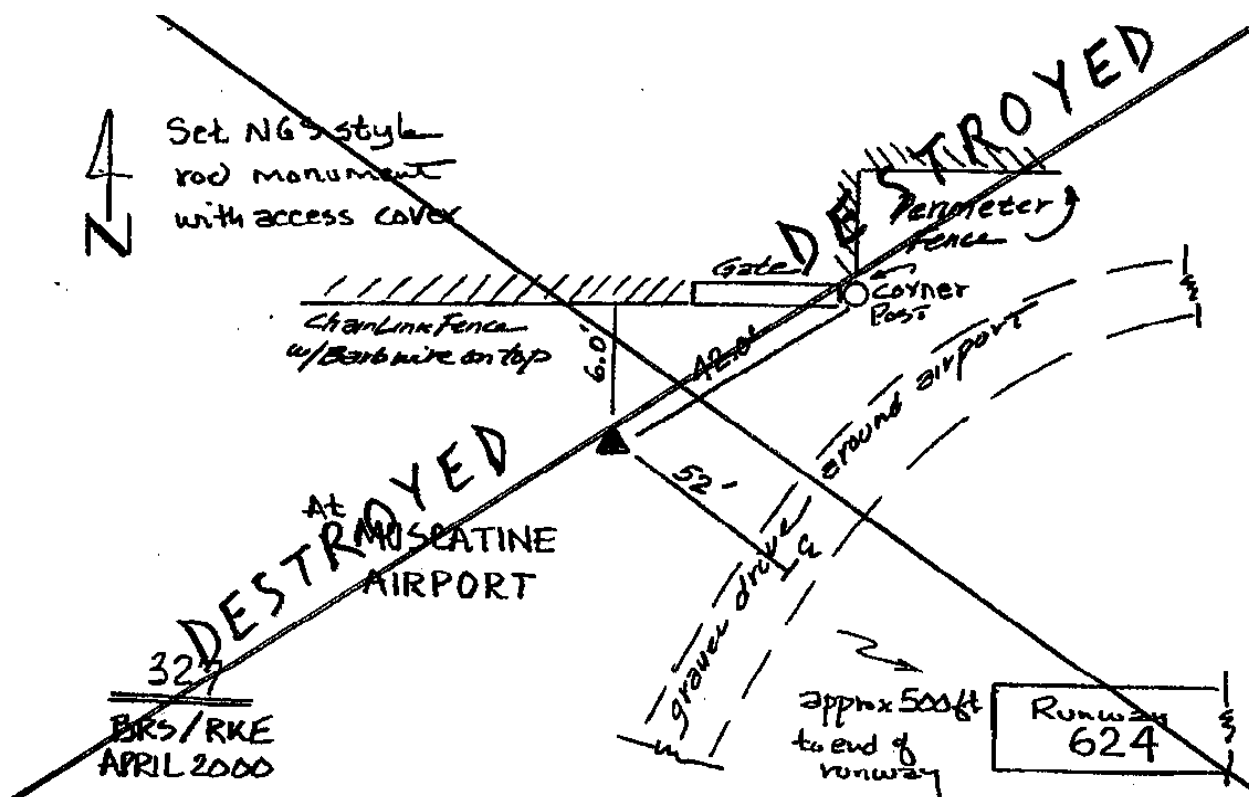

This document was prepared by DCI on November 10, 2014 for use by Muscatine County, Iowa