

**Muscatine County, Iowa**

Horizontal Datum: **NAD 83(2011)** - Vertical Datum: **NAVD 1988**

Iowa State Plane South Zone (1402)

Iowa Regional Coordinate System Zone 14 Burlington

US Survey Feet

**2014**

Point Name: **505**

**Designation:** USGS vertical control station "1 DRL 1964"

NAD 83(NA2011) Latitude: **N41°21'24.58102"** Longitude: **W91°14'21.11590"**

NAVD 88 Ortho Height: **720.910sft** Ellip. Ht: **612.897sft** **Geoid12A**

Iowa South Zone (1402) Northing: **502403.430sft** Easting: **2260996.215sft**  
Mapping Angle: **1°29'21"** Combination Scale Factor: **0.999922818**

IaRCS Zone 14 Northing: **6603265.770sft** Easting: **24502965.393sft**  
Mapping Angle: **0°00'26"** Combination Scale Factor: **0.9999887639**

**Monument Type:** A standard bench disk set in the top of a concrete post.

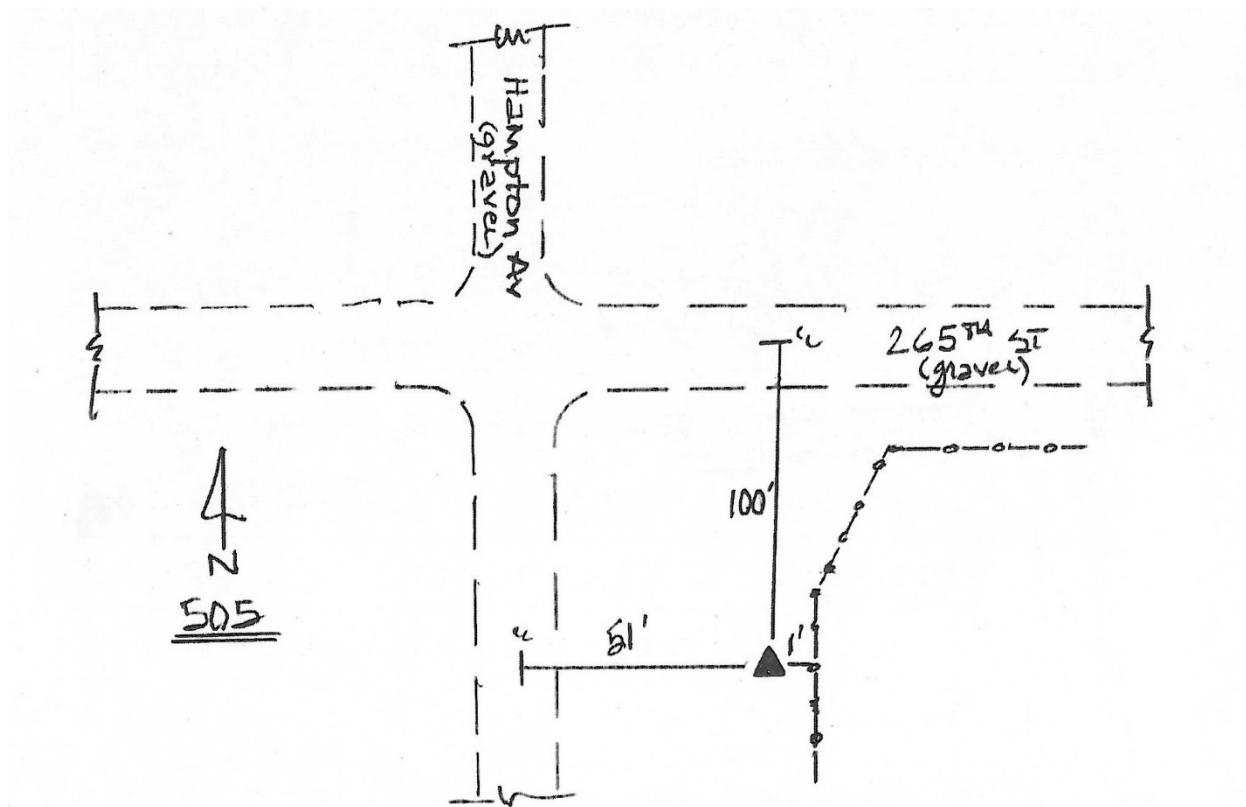

*This document was prepared by DCI on November 10, 2014 for use by Muscatine County, Iowa*