

Muscatine County, Iowa

Horizontal Datum: **NAD 83(2011)** - Vertical Datum: **NAVD 1988**

Iowa State Plane South Zone (1402)

Iowa Regional Coordinate System Zone 14 Burlington

US Survey Feet

2014

Point Name: **506**

Designation: CBN control station "ARDON AZ MK RESET" PID: AE2148

NAD 83(NA2011) Latitude: **N41°26'37.28223"** Longitude: **W91°10'26.06733"**

NAVD 88 Ortho Height: **741.890sft** Ellip. Ht: **634.055sft** **Geoid12A**

Iowa South Zone (1402) Northing: **534513.340sft** Easting: **2278067.910sft**

Mapping Angle: **1°31'56"** Combination Scale Factor: **0.999927072**

IaRCS Zone 14 Northing: **6634925.445sft** Easting: **24520862.949sft**

Mapping Angle: **0°03'01"** Combination Scale Factor: **0.9999882418**

Monument Type: A survey disk on a copper clad steel rod w/o sleeve (10 FT. +).

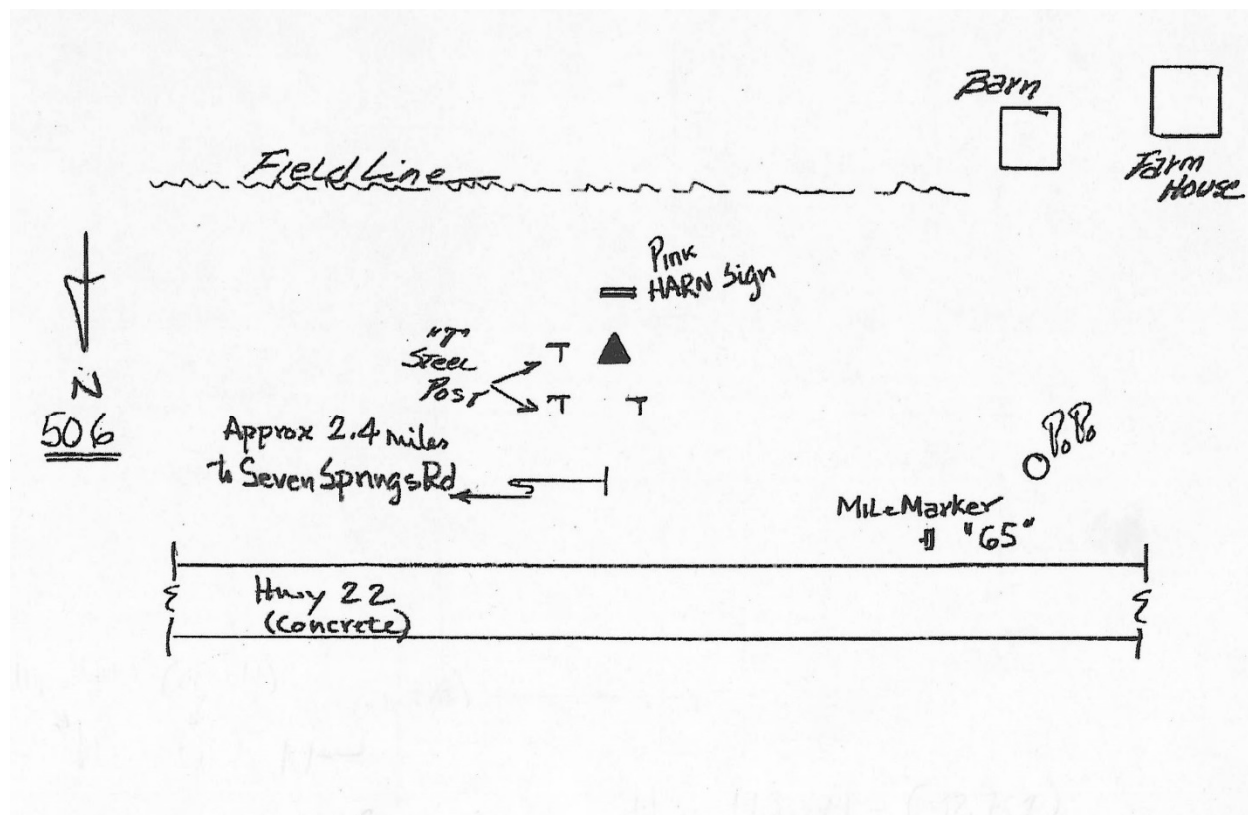

This document was prepared by DCI on November 10, 2014 for use by Muscatine County, Iowa