

**Page County, Iowa**  
Iowa South Zone (1402)  
Horiz. Datum: **NAD83(NA2011)**  
Vert. Datum: NAVD 1988  
US Survey Feet  
**2013**

Point Name: **1032**

**Designation:** CBN horizontal control station "SCHEPORT" PID: LF1489

Northing: **267038.60sft** Easting: **1217366.11sft**

Orthometric Height: **985.43sft** Ellipsoid Height: **883.74sft** **Geoid12A**

Latitude: **N40°43'21.96245"** Longitude: **W95°01'34.79895"**

Mapping Angle: **-1°00'19"** Combination Scale Factor: **0.999940798**

**Monument Type:** The station mark is a stainless steel rod/datum point set in a pvc sleeve with access through a 5" logo cap. Mark is 1.0ft east of pink state HARN sign.

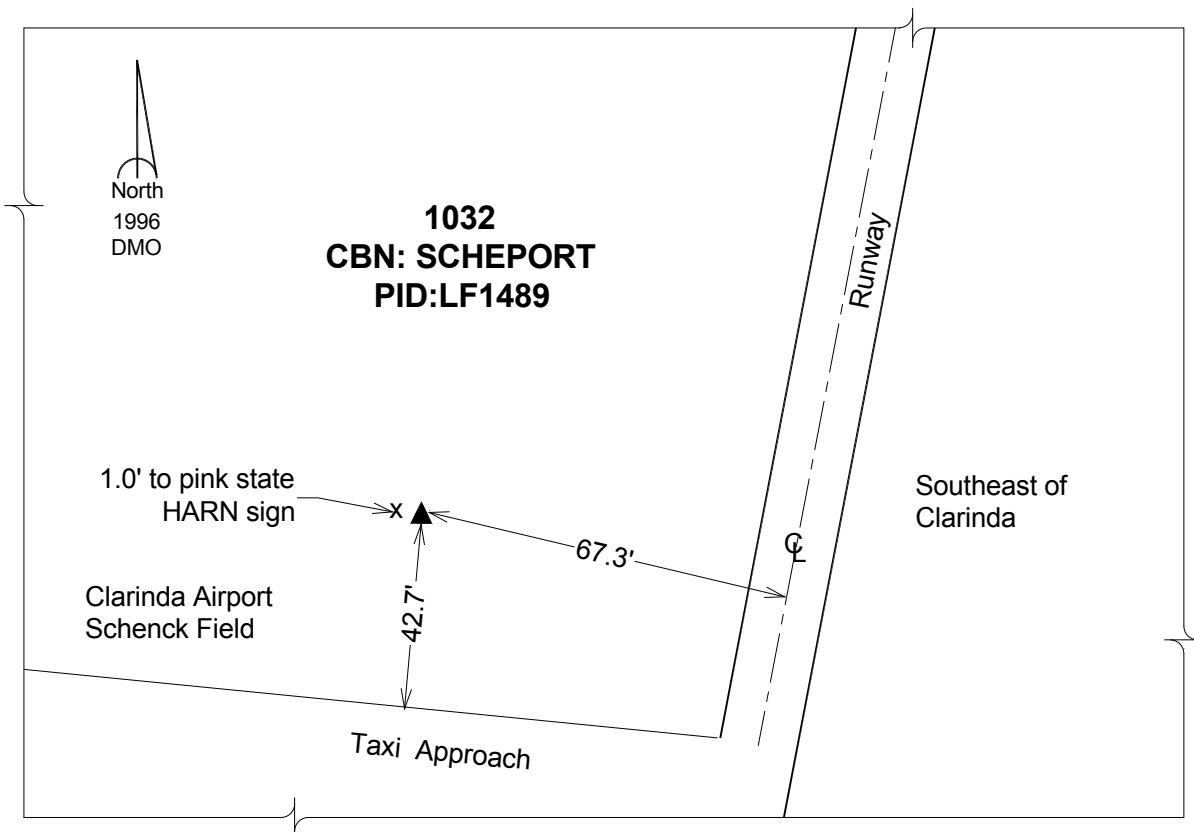

*This document was prepared by DCI on 04-16-2013 for use by Page County, Iowa.*