

Page County, Iowa
Iowa South Zone (1402)
Horiz. Datum: **NAD83(NA2011)**
Vert. Datum: NAVD 1988
US Survey Feet
2013

Point Name: **1060**

Designation: CBN Horiz & 1st order Vert control station "C 342" PID: LF1452

Northing: **154209.41sft** Easting: **1051365.93sft**

Orthometric Height: **889.59sft** Ellipsoid Height: **790.59sft** **Geoid12A**

Latitude: **N40°24'12.97244"** Longitude: **W95°36'54.53263"**

Mapping Angle: **-1°23'36"** Combination Scale Factor: **1.000006697**

Monument Type: The station mark is a stainless steel rod/datum point set in a pvc sleeve with access through a 5" logo cap. Mark is leaning to the east approx. 0.2ft.

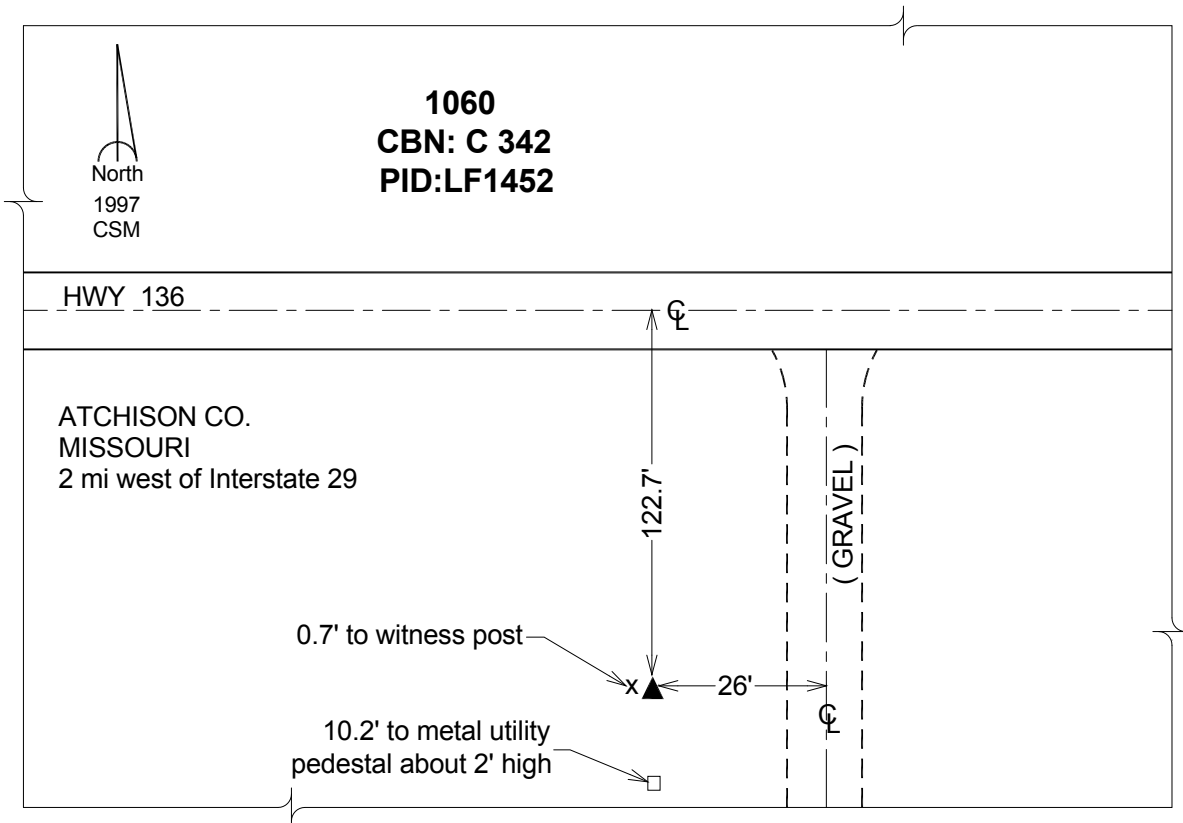

This document was prepared by DCI on 04-16-2013 for use by Page County, Iowa.