

**Palo Alto County, Iowa**  
Iowa North Zone (1401)  
Horiz. Datum: NAD83(1996)  
Vert. Datum: NAVD 1988  
US Survey Feet  
**2005**

Point Name: **428**

**Designation:** PA-0428 Palo Alto Co GPS Control Point (Set by Palo Alto Co. in 2004)

Northing: **3906166.36**sft Easting: **4669502.09**sft

Orthometric Height: **1266.61**sft Ellipsoid Height: **1173.00**sft **Geoid03**

Latitude: **43°12'43.34843"N** Longitude: **94°26'39.54251"W**

Mapping Angle: **-0°38'24"** Combination Scale Factor: **0.999934510**

**Monument Type:** Berntsen Top Security Rod Monument with a 3-1/4" dia. domed survey cap and permanent magnet encased in a 5"dia. PVC pipe with a NGS style aluminum access cover.

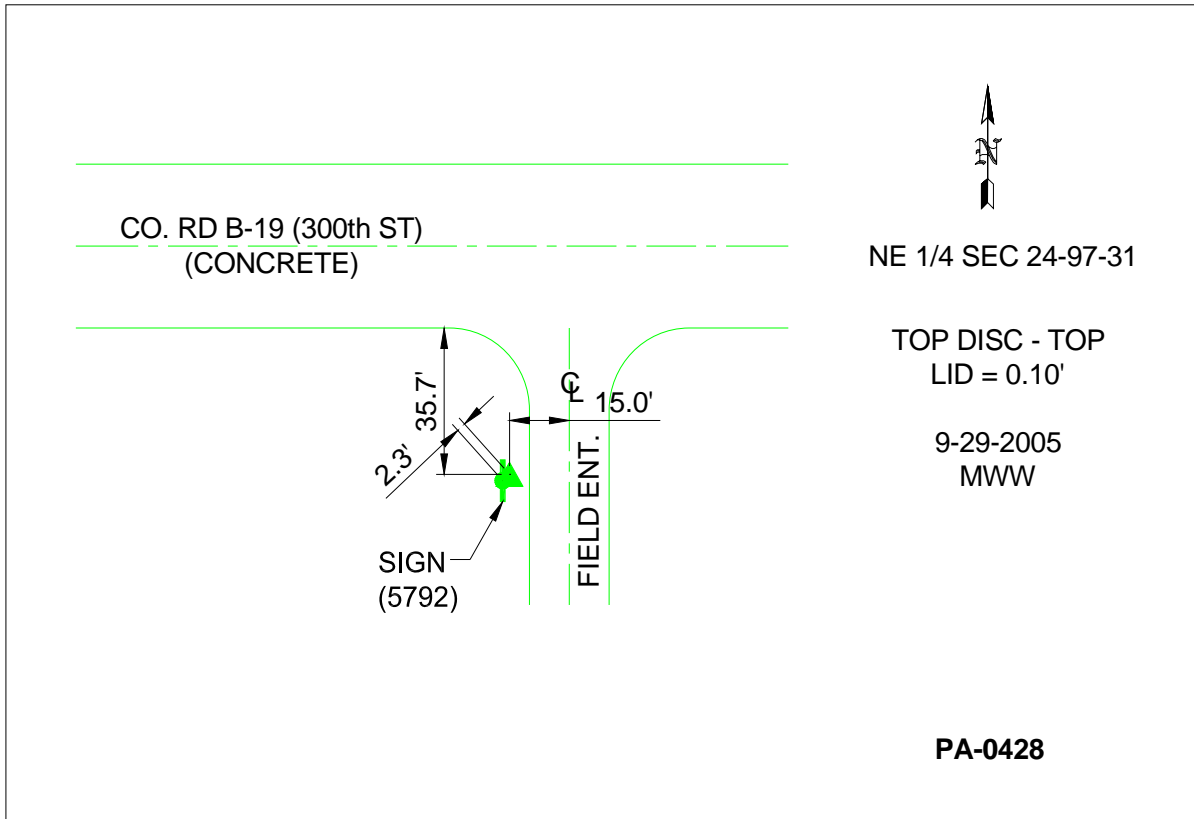

*This document was prepared by DCI and GBC for use by Palo Alto County, Iowa.*