

Palo Alto County, Iowa
Iowa North Zone (1401)
Horiz. Datum: NAD83(1996)
Vert. Datum: NAVD 1988
US Survey Feet
2005

Point Name: **436**

Designation: PA-0436 Palo Alto Co GPS Control Point (Set by Palo Alto Co. in 2004)

Northing: **3896220.45sft** Easting: **4638386.25sft**

Orthometric Height: **1284.60sft** Ellipsoid Height: **1190.94sft** **Geoid03**

Latitude: **43°11'01.47596"N** Longitude: **94°33'37.99677"W**

Mapping Angle: **-0°43'08"** Combination Scale Factor: **0.999929080**

Monument Type: Berntsen Top Security Rod Monument with a 3-1/4" dia. domed survey cap and permanent magnet encased in a 5"dia. PVC pipe with a NGS style aluminum access cover.

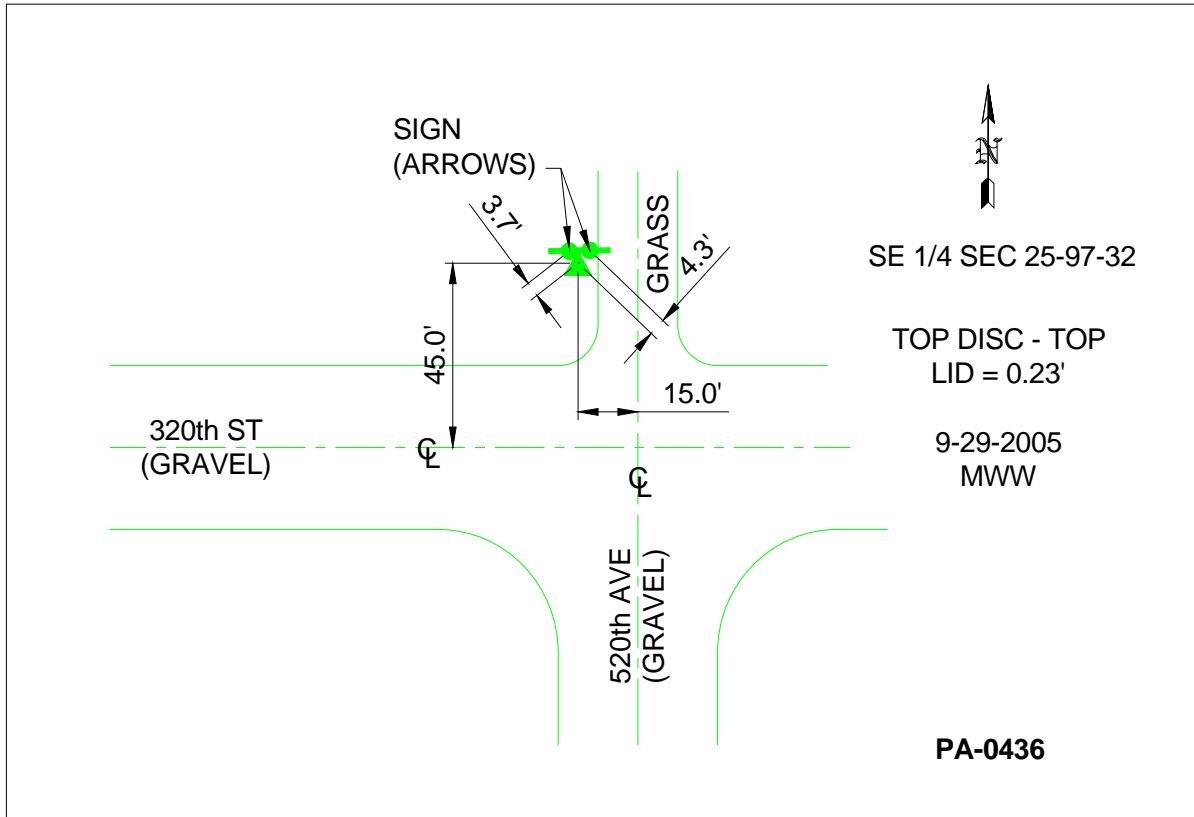

This document was prepared by DCI and GBC for use by Palo Alto County, Iowa.