

Palo Alto County, Iowa
Iowa North Zone (1401)
Horiz. Datum: NAD83(1996)
Vert. Datum: NAVD 1988
US Survey Feet
2005

Point Name: **474**

Designation: PA-0474 Palo Alto Co GPS Control Point (Set by Palo Alto Co. in 2004)

Northing: **3827959.21**sft Easting: **4605898.68**sft

Orthometric Height: **1207.11**sft Ellipsoid Height: **1112.89**sft **Geoid03**

Latitude: **42°59'43.04926"N** Longitude: **94°40'43.60232"W**

Mapping Angle: **-0°47'56"** Combination Scale Factor: **0.999908590**

Monument Type: Berntsen Top Security Rod Monument with a 3-1/4" dia. domed survey cap and permanent magnet encased in a 5"dia. PVC pipe with a NGS style aluminum access cover.

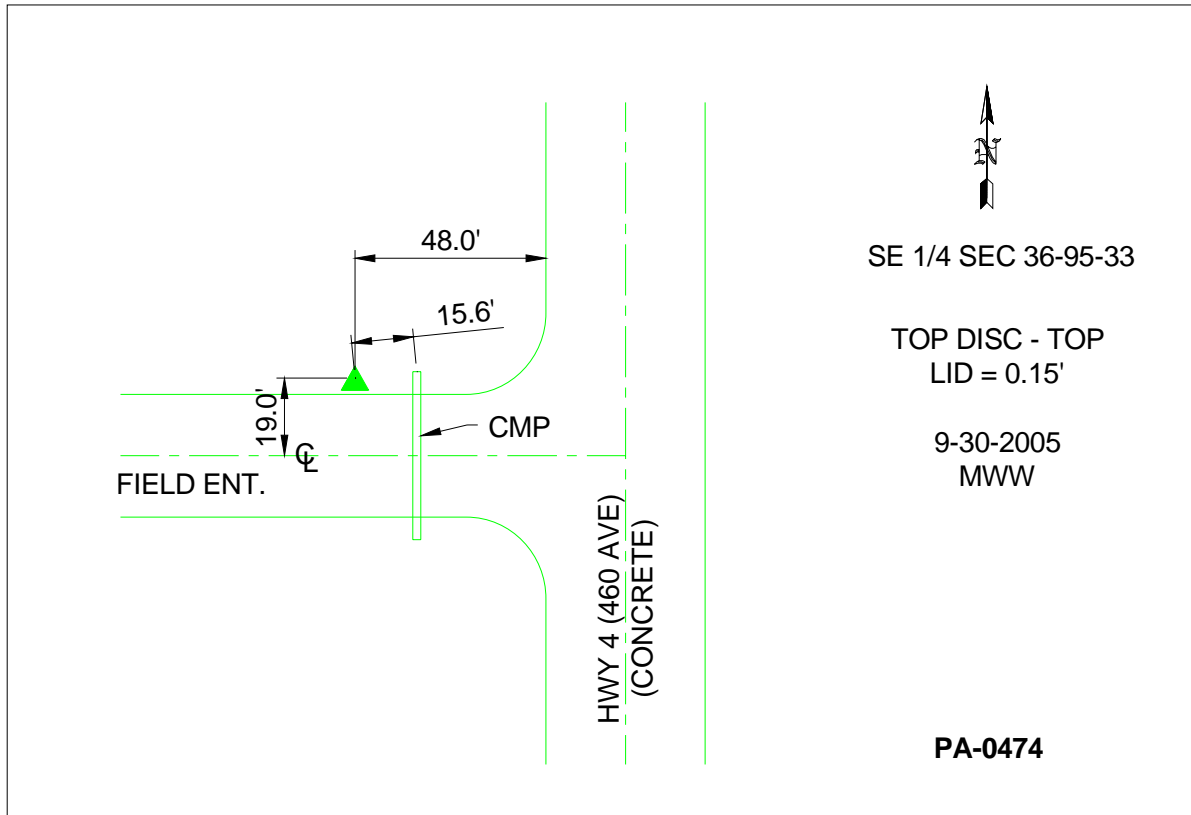

This document was prepared by DCI and GBC for use by Palo Alto County, Iowa.