

Palo Alto County, Iowa
Iowa North Zone (1401)
Horiz. Datum: NAD83(1996)
Vert. Datum: NAVD 1988
US Survey Feet
2005

Point Name: **477**

Designation: PA-0477 Palo Alto Co GPS Control Point (Set by Palo Alto Co. in 2004)

Northing: **3827244.62sft** Easting: **4653192.43sft**

Orthometric Height: **1172.34sft** Ellipsoid Height: **1078.17sft** **Geoid03**

Latitude: **42°59'42.01652"N**

Longitude: **94°30'07.13326"W**

Mapping Angle: **-0°40'45"**

Combination Scale Factor: **0.999910220**

Monument Type: Berntsen Top Security Rod Monument with a 3-1/4" dia. domed survey cap and permanent magnet encased in a 5"dia. PVC pipe with a NGS style aluminum access cover.

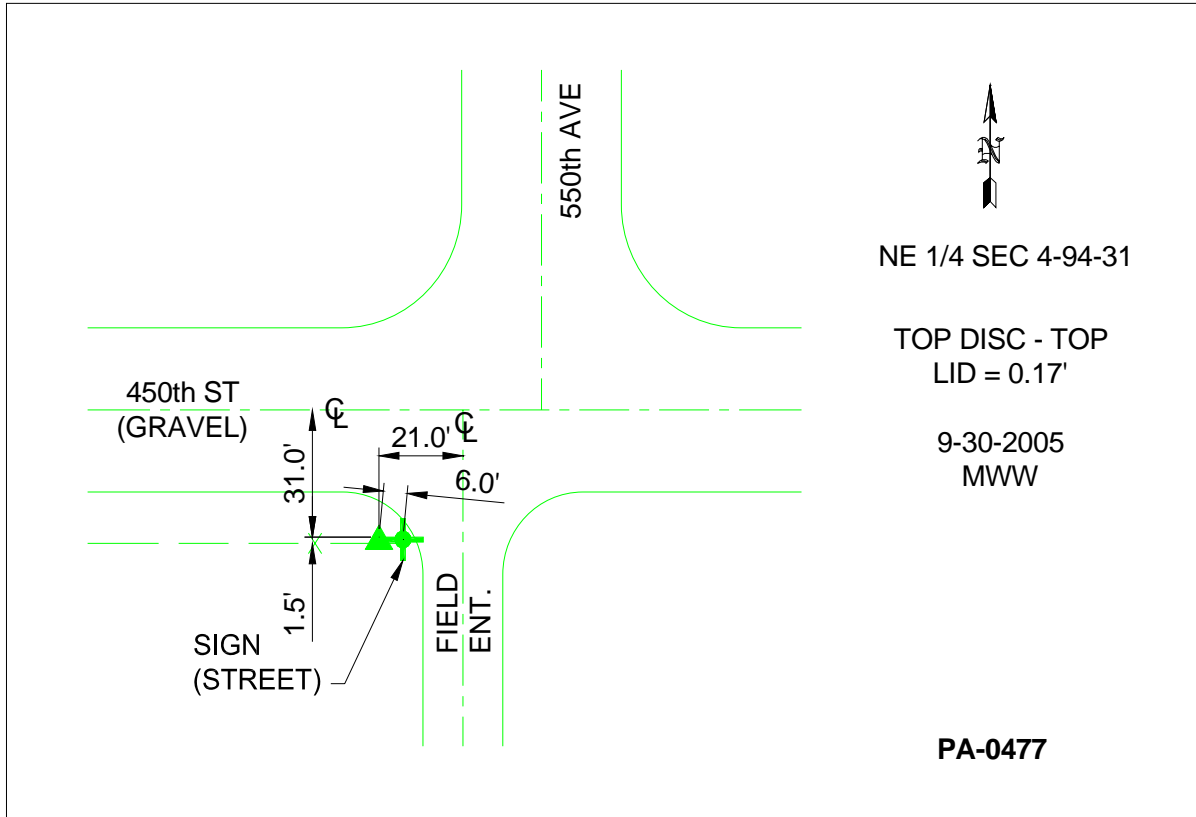

This document was prepared by DCI and GBC for use by Palo Alto County, Iowa.