

Palo Alto County, Iowa
Iowa North Zone (1401)
Horiz. Datum: NAD83(1996)
Vert. Datum: NAVD 1988
US Survey Feet
2005

Point Name: **491**

Designation: PA-0491 Palo Alto Co GPS Control Point (Set by Palo Alto Co. in 2004)

Northing: **3797898.40sft** Easting: **4558058.34sft**

Orthometric Height: **1338.19sft** Ellipsoid Height: **1243.80sft** **Geoid03**

Latitude: **42°54'39.06820"N** Longitude: **94°51'20.78747"W**

Mapping Angle: **-0°55'08"** Combination Scale Factor: **0.999895020**

Monument Type: Berntsen Top Security Rod Monument with a 3-1/4" dia. domed survey cap and permanent magnet encased in a 5"dia. PVC pipe with a NGS style aluminum access cover.

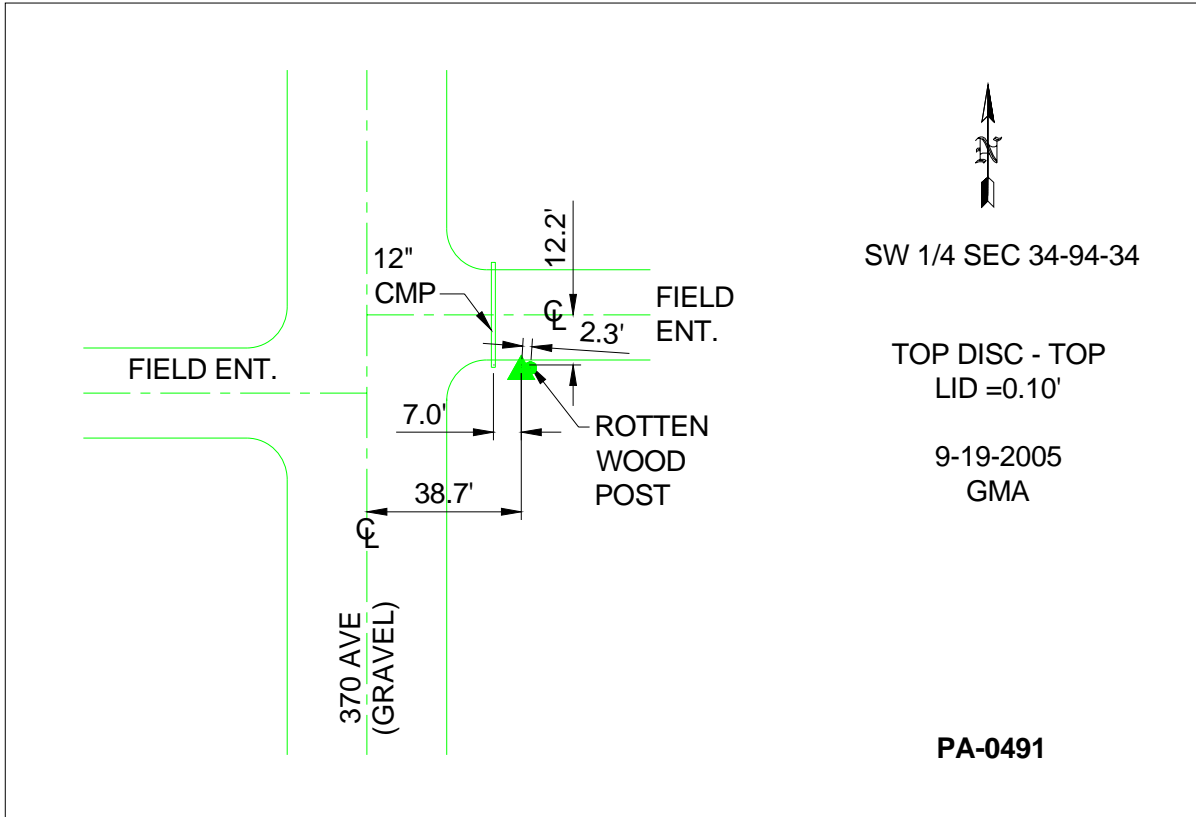

This document was prepared by DCI and GBC for use by Palo Alto County, Iowa.