

ok

501 774501-4

SET 5/8 INCH DIAMETER ROD WITH 2.5 INCH DIAMETER CAP, 0.3 FEET BELOW GROUND, STAMPED "POTTAWATTAMIE CO. 1998, 501, 774501-4". LOCATED APPROXIMATELY 17 FEET EAST OF EAST EDGE HWY L-16, 6 FEET SOUTH OF ELECTRIC BOX, 13 FEET NORTH OF A POWER POLE ON THE SOUTH SIDE OF YORK ROAD. ON THE MISSOURI VALLEY 7.5 MINUTE QUADRANGLE.

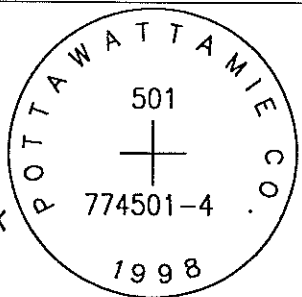

PT#	NAME OR DESIGNATION	GEODETTIC NAD83 (1996)		HEIGHT ELLIPSOID METERS	SP NAD83 (1996) IOWA SOUTH HEIGHT			SP NAD83 (1996) IOWA SOUTH HEIGHT		
		LATITUDE (North) DEG MIN SEC	LONGITUDE (West) DEG MIN SEC		NORTHING METERS	EASTING METERS	NAV88 METERS	NORTHING US FEET	EASTING US FEET	NAV88 US FEET
501	774501-4	41 30 23.60989	95 58 31.01245	275.75	170243.326	293379.978	304.28	558539.98	962530.81	998.3

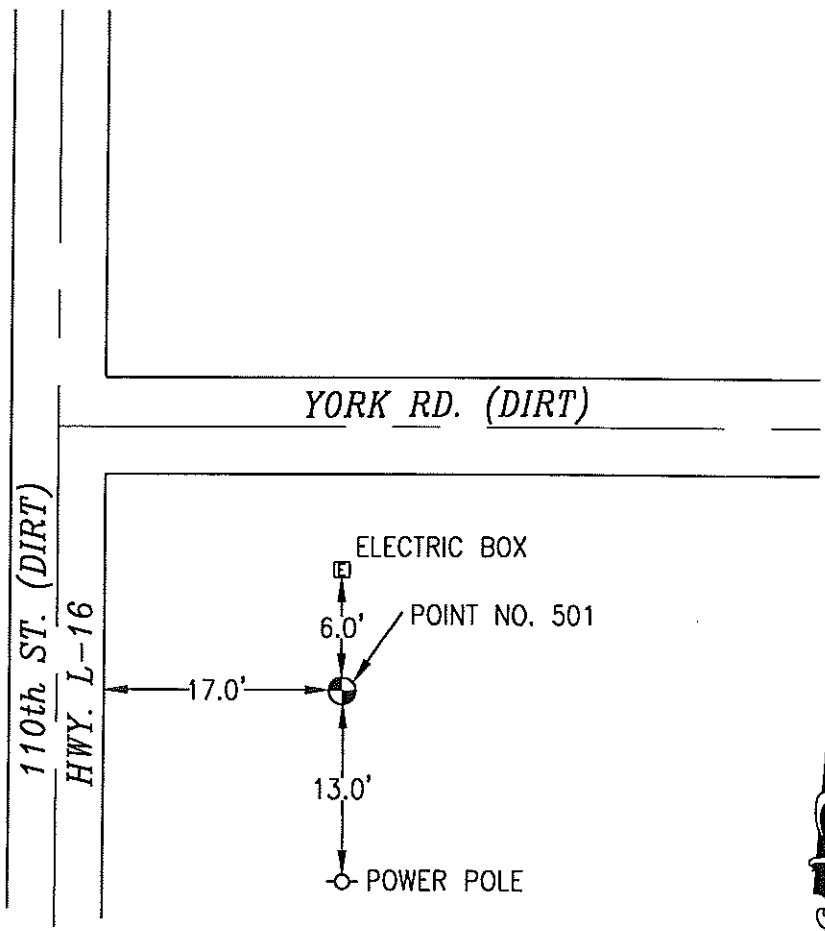

NOT TO SCALE

LOCATION DIAGRAM
POTTAWATTAMIE COUNTY IOWA
GIS Mapping Project
GPS Survey Report

MERRICK
Engineers & Architects
2450 S. Pearl Street Aurora, Colorado 80014 (303)751-0741
Job Number: 50013142
Date: October 23, 1998