

OK

505 774206-3

SET 5/8 INCH DIAMETER ROD WITH 2.5 INCH DIAMETER CAP, 0.15 FEET BELOW GROUND, STAMPED "POTTAWATTAMIE CO. 1998, 505, 774206-3". LOCATED APPROXIMATELY 11 FEET EAST OF THE EAST EDGE OF 240TH STREET, 93 FEET NORTH OF A DEAD END SIGN, 1.3 FEET WEST OF A CARSONITE POST, ON THE NORTH SIDE OF WHIPPOORWILL ROAD. ON THE UNDERWOOD 7.5 MINUTE QUADRANGLE.

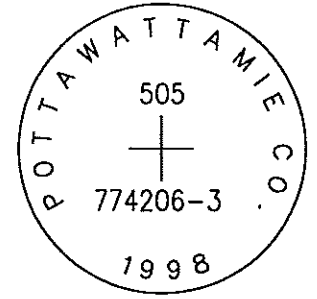

PT#	NAME OR DESIGNATION	GEODETC NAD83 (1996)			HEIGHT ELLIPSOID METERS	SP NAD83 (1996) IOWA SOUTH HEIGHT			SP NAD83 (1996) IOWA SOUTH HEIGHT		
		LATITUDE (North) DEG MIN SEC	LONGITUDE (West) DEG MIN SEC			NORTHING METERS	EASTING METERS	NAVD88 METERS	NORTHING US FEET	EASTING US FEET	NAVD88 US FEET
505	774206-3	41 29 31.93521	95 43 36.06037		303.14	168088.819	314085.679	331.82	551471.40	1030462.77	1088.6

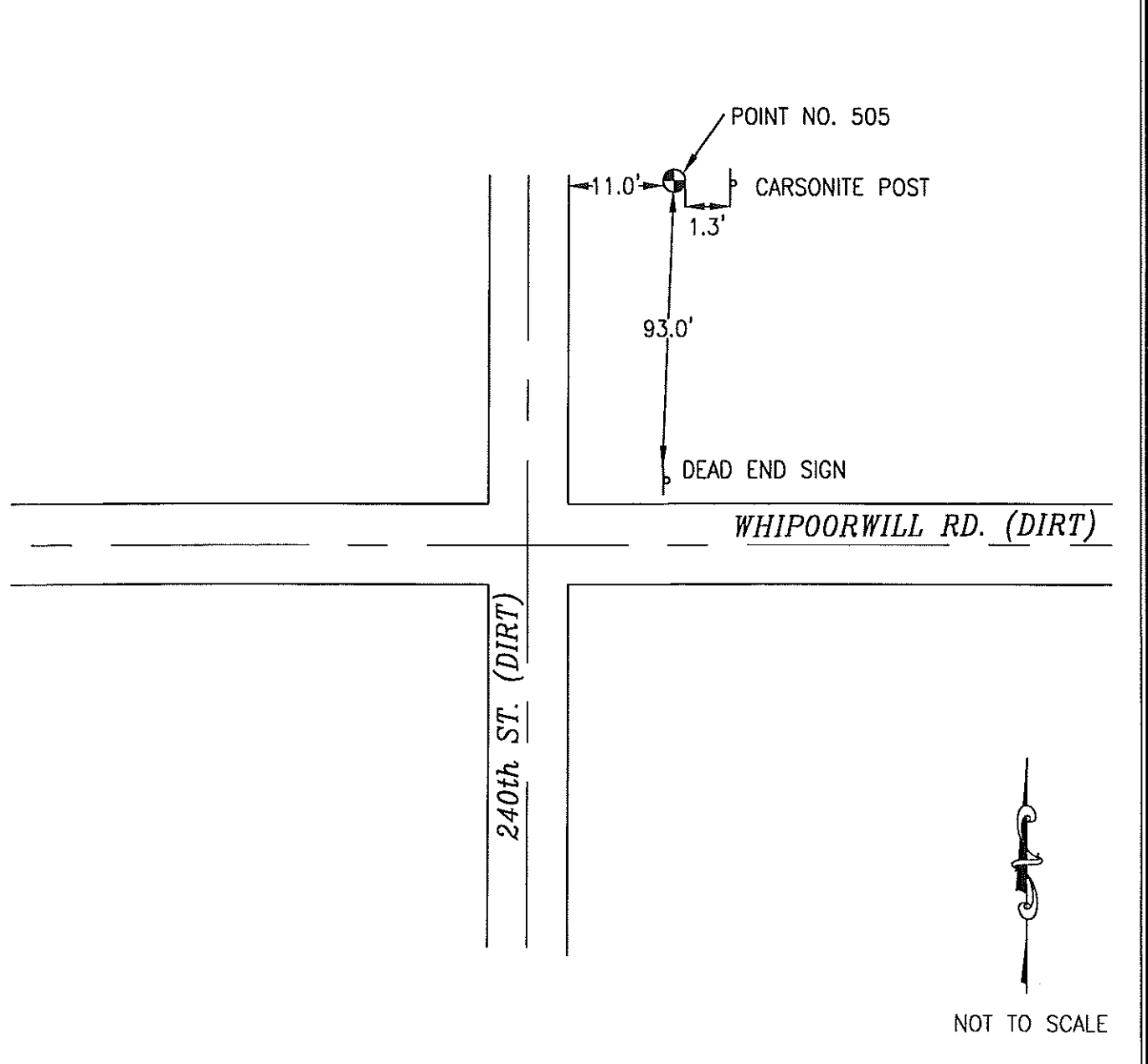

NOT TO SCALE

LOCATION DIAGRAM
 POTTAWATTAMIE COUNTY IOWA
 GIS Mapping Project
 GPS Survey Report

MERRICK
 Engineers & Architects
 2450 S. Pearla Street Aurora, Colorado 80014 (303)751-0741
 Job Number: 50013142
 Date: October 23, 1998