

OK

507 774202-1

SET 5/8 INCH DIAMETER ROD WITH 2.5 INCH DIAMETER CAP, 0.1 FEET BELOW GROUND, STAMPED "POTTAWATTAMIE CO. 1998, 507, 774202-1". LOCATED APPROXIMATELY 18 FEET SOUTH OF THE SOUTH EDGE OF YORK ROAD, 8.7 FEET WEST OF TUSTIN LANE SIGN, 1.5 FEET NORTH OF CARSONITE POST. ON THE HARD SCRATCH 7.5 MINUTE QUADRANGLE.

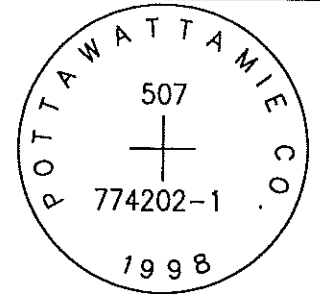

PT#	NAME OR DESIGNATION	GEODETIC NAD83 (1996)		HEIGHT ELLIPSOID METERS	SP NAD83 (1996) IOWA SOUTH HEIGHT		SP NAD83 (1996) IOWA SOUTH HEIGHT			
		LATITUDE (North) DEG MIN SEC	LONGITUDE (West) DEG MIN SEC		NORTHING METERS	EASTING METERS	NORTHING US FEET	EASTING US FEET	NAVD88 METERS	NAVD88 US FEET
507	774202-1	41 30 20.91139	95 37 54.93984	336.68	169401.052	322032.604	365.34	555776.62	1056535.30	1198.6

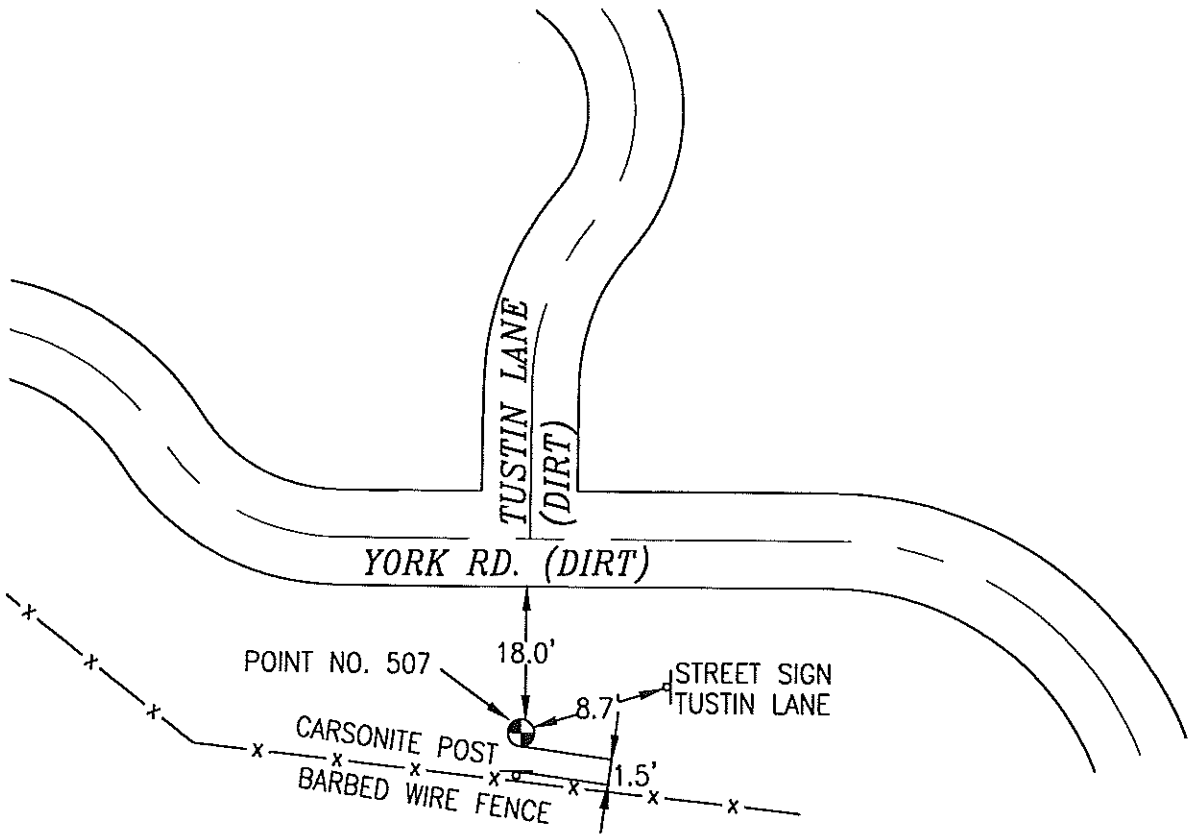

NOT TO SCALE

LOCATION DIAGRAM
POTTAWATTAMIE COUNTY IOWA
GIS Mapping Project
GPS Survey Report

MERRICK
Engineers & Architects
2450 S. Peoria Street Aurora, Colorado 80014 (303)751-0741
Job Number: 50013142
Date: October 23, 1998