

ok

514 773803-4

SET 5/8 INCH DIAMETER ROD WITH 2.5 INCH DIAMETER CAP, 0.6 FEET BELOW GROUND, STAMPED "POTTAWATTAMIE CO. 1998, 514, 773803-4". LOCATED APPROXIMATELY 21 FEET EAST OF THE EAST EDGE OF 510TH STREET, 2 FEET WEST OF A CARSONITE POST AND FENCE, 19 FEET SOUTH OF A POWERPOLE, 16.5 FEET SOUTH OF A STOP SIGN, ON THE PRAIRIE ROSE LAKE 7.5 MINUTE QUADRANGLE.

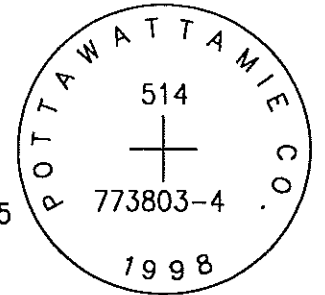

PT#	NAME OR DESIGNATION	GEODEIC NAD83 (1996)		HEIGHT ELLIPSOID METERS	SP NAD83 (1996) IOWA SOUTH HEIGHT			SP NAD83 (1996) IOWA SOUTH HEIGHT		
		LATITUDE (North) DEG MIN SEC	LONGITUDE (West) DEG MIN SEC		NORTHING METERS	EASTING METERS	NAVD88 METERS	NORTHING US FEET	EASTING US FEET	NAVD88 US FEET
514	773803-4	41 30 19.08189	95 12 44.74627	374.71	168570.758	357044.958	402.55	553052.56	1171405.00	1320.7

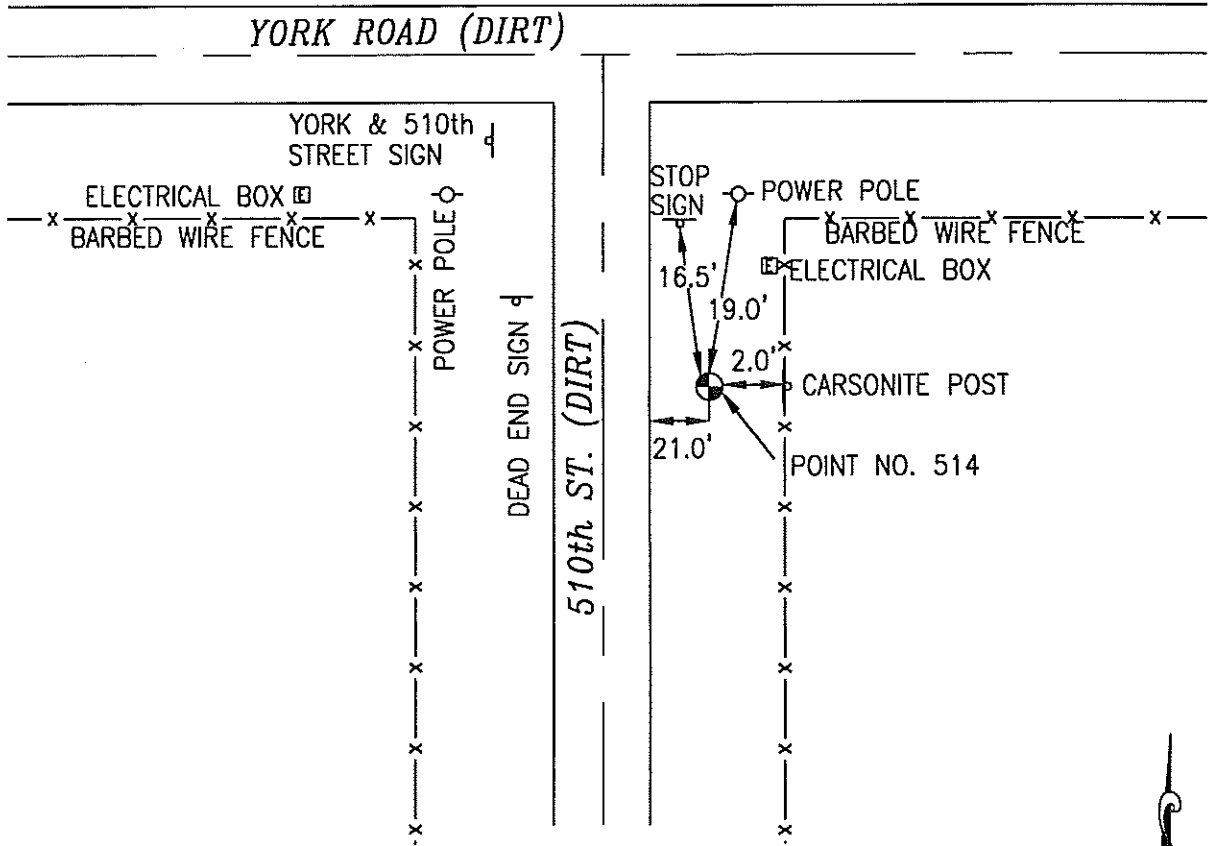

NOT TO SCALE

LOCATION DIAGRAM
POTTAWATTAMIE COUNTY IOWA
GIS Mapping Project
GPS Survey Report

MERRICK
Engineers & Architects
2450 S. Pearla Street Aurora, Colorado 80014 (303)751-0741
Job Number: 50013142
Date: October 23, 1998