

OK

525 774013-3

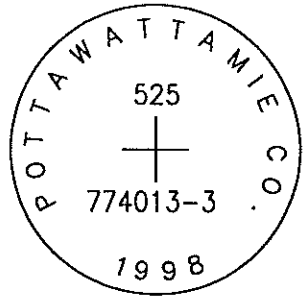

SET 5/8 INCH DIAMETER ROD WITH 2.5 INCH DIAMETER CAP, 0.4 FEET BELOW GROUND, STAMPED "POTTAWATTAMIE CO. 1998, 525, 774013-3". LOCATED APPROXIMATELY 27 FEET EAST OF THE EAST EDGE OF GRAVEL 410TH STREET, 21 FEET NORTH OF THE NORTH EDGE OF GRAVEL TEAKWOOD ROAD, 11 FEET NORTHEAST OF A STOP SIGN, 8 FEET EAST OF ANGLE POINT IN BARBED WIRE FENCE, 1.8 FEET SOUTH OF A CARSONITE POST. ON THE AVOCA NW 7.5 MINUTE QUADRANGLE.

PT#	NAME OR DESIGNATION	GEODETC NAD83 (1996)			HEIGHT ELLIPSOID METERS	SP NAD83 (1996) IOWA SOUTH HEIGHT			SP NAD83 (1996) IOWA SOUTH HEIGHT		
		LATITUDE (North) DEG MIN SEC	LONGITUDE (West) DEG MIN SEC			NORTHING METERS	EASTING METERS	NAVD88 METERS	NORTHING US FEET	EASTING US FEET	NAVD88 US FEET
525	774013-3	41 27 44.36627	95 24 10.48055		371.66	164129.433	341041.385	399.70	538481.31	1118899.94	1311.4

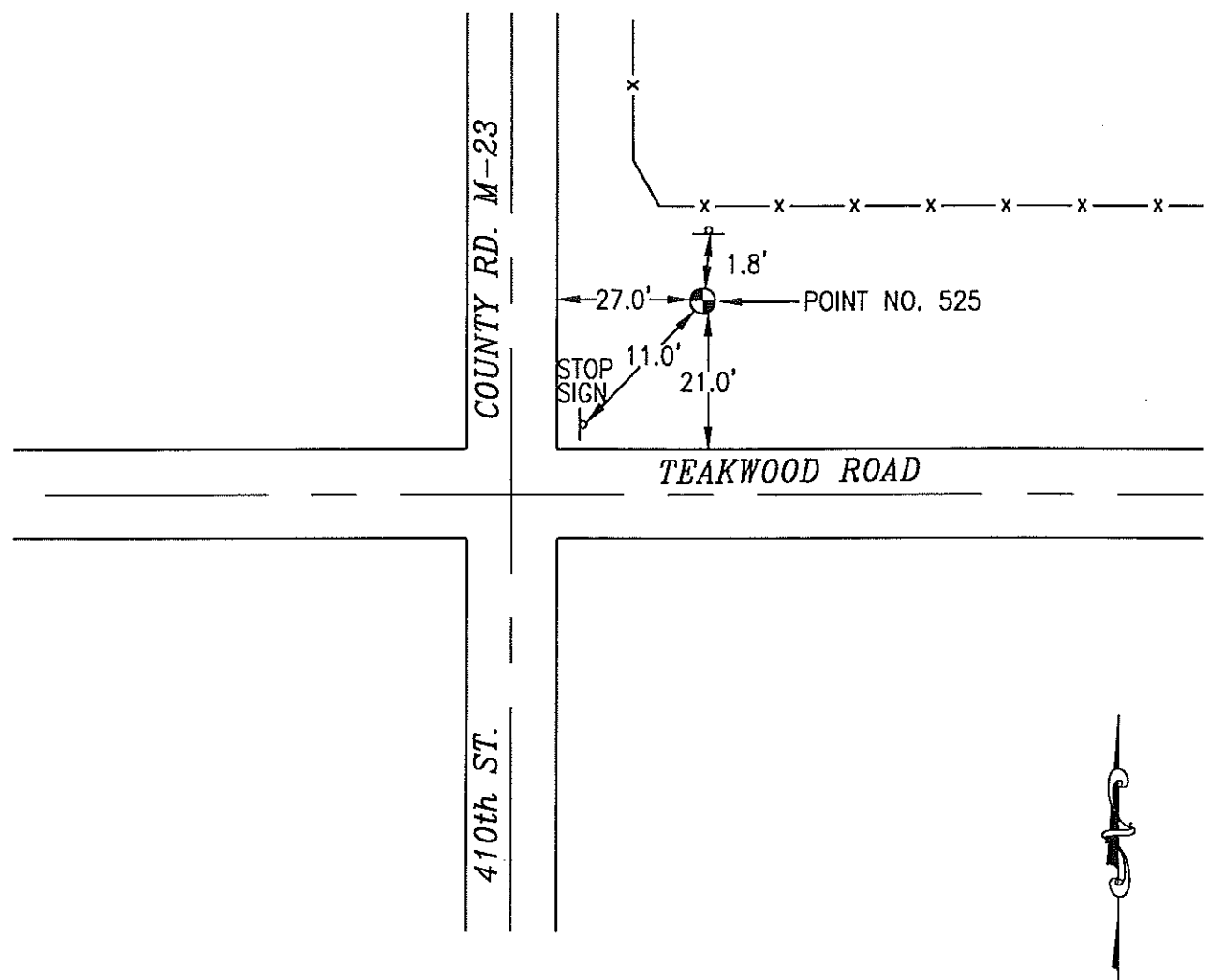

NOT TO SCALE

LOCATION DIAGRAM  
 POTTAWATTAMIE COUNTY IOWA  
 GIS Mapping Project  
 GPS Survey Report

**MERRICK**  
 Engineers & Architects  
 2450 S. Pearl Street Aurora, Colorado 80014 (303)751-0741  
 Job Number: 50013142  
 Date: October 26, 1998