

60 NW

526 E150

FOUND 3.5 INCH DIAMETER BRASS CAP, FLUSH WITH GROUND, STAMPED "U. S. COAST AND GEODETIC SURVEY BENCHMARK, E150 1949". LOCATED APPROXIMATELY 15.5 FEET SOUTH OF THE SOUTH EDGE OF E. WILSON STREET, 25.5 FEET EAST OF THE EAST EDGE OF N. CHESTNUT STREET, 9.4 FEET EAST OF A WATER VALVE, 7.5 FEET EAST OF A FIRE HYDRANT. ON THE AVOCA 7.5 MINUTE QUADRANGLE.

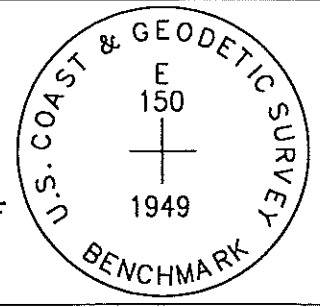

PT#	NAME OR DESIGNATION	GEODETIC NAD83 (1996)		HEIGHT ELLIPSOID METERS	SP NAD83 (1996) IOWA SOUTH HEIGHT			SP NAD83 (1996) IOWA SOUTH HEIGHT		
		LATITUDE (North) DEG MIN SEC	LONGITUDE (West) DEG MIN SEC		NORTHING METERS	EASTING METERS	NAVD88 METERS	NORTHING US FEET	EASTING US FEET	NAVD88 US FEET
526	E 150	41 29 05.75645	95 20 10.53929	321.46	166520.060	346661.144	349.48	546324.56	1137337.44	1146.6

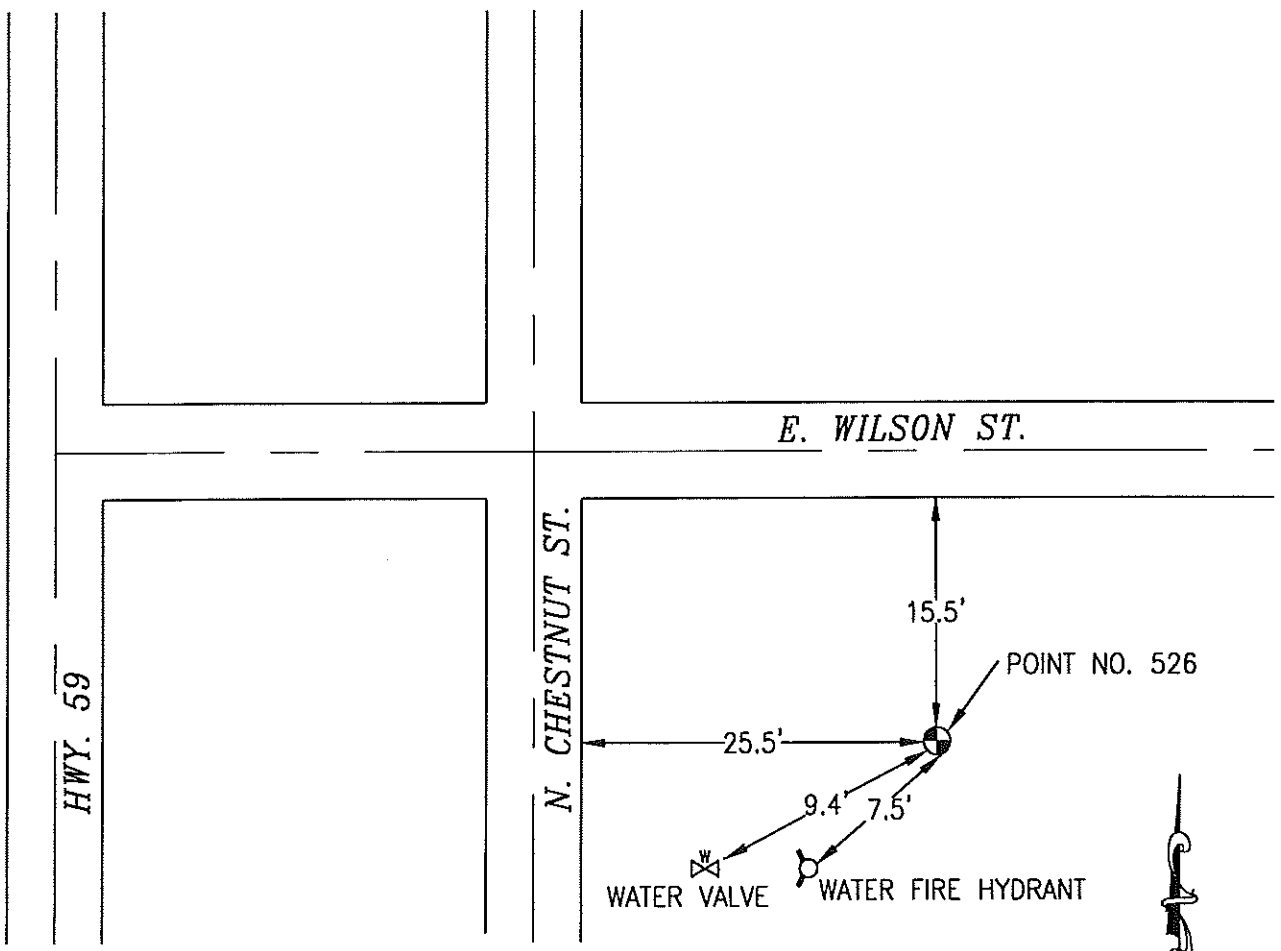

NOT TO SCALE

LOCATION DIAGRAM
 POTTAWATTAMIE COUNTY IOWA
 GIS Mapping Project
 GPS Survey Report

MERRICK
 Engineers & Architects
 2450 S. Pearl Street Aurora, Colorado 80014 (303)751-0741
 Job Number: 50013142
 Date: October 23, 1998