

OK

539 774033-3

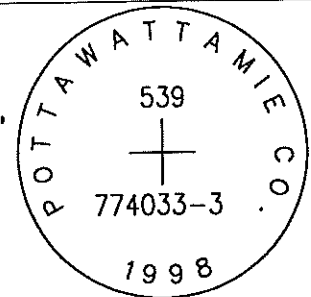

SET 5/8 INCH DIAMETER ROD WITH 2.5 INCH DIAMETER CAP, 0.3 BELOW GROUND, STAMPED "POTTAWATTAMIE CO. 1998, 539, 774033-3". LOCATED APPROXIMATELY 31 FEET EAST OF THE EAST EDGE OF 380TH STREET, 31 FEET NORTH OF THE NORTH EDGE OF ROSEWOOD ROAD, 6 FEET NORTHEAST OF A STREET SIGN, 21 FEET NORTHEAST OF A STOP SIGN, 3 FEET SOUTH OF A SET ORANGE CARSONITE POST. ON THE AVOCA NW 7.5 MINUTE QUADRANGLE.

PT#	NAME OR DESIGNATION	GEODETC NAD83 (1996)		HEIGHT ELLIPSOID METERS	SP NAD83 (1996) IOWA SOUTH HEIGHT			SP NAD83 (1996) IOWA SOUTH HEIGHT		
		LATITUDE (North) DEG MIN SEC	LONGITUDE (West) DEG MIN SEC		NORTHING METERS	EASTING METERS	NAVD88 METERS	NORTHING US FEET	EASTING US FEET	NAVD88 US FEET
539	774033-3	41 25 08.14166	95 27 38.19412	360.18	159418.269	336113.780	388.13	523024.77	1102733.29	1273.4

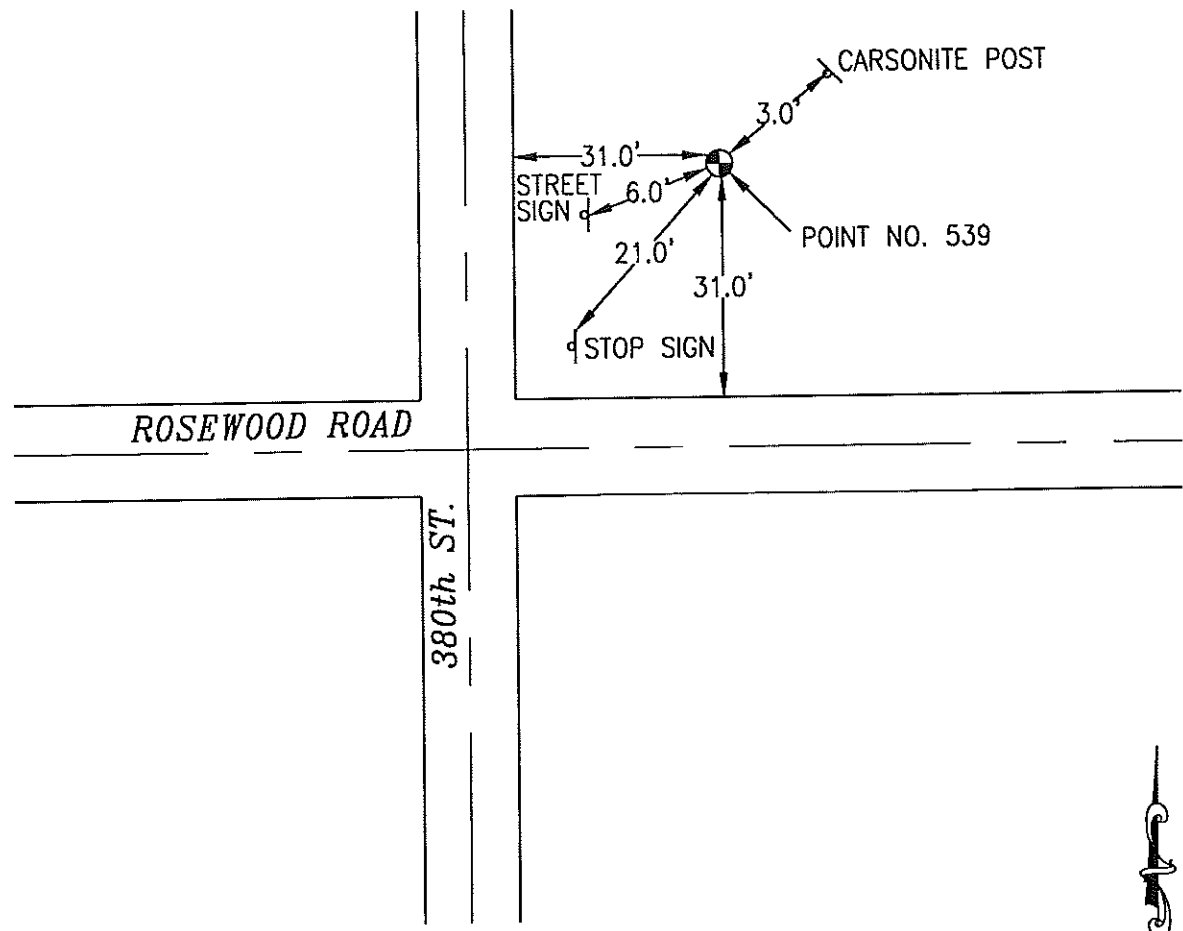

NOT TO SCALE

LOCATION DIAGRAM
 POTTAWATTAMIE COUNTY IOWA
 GIS Mapping Project
 GPS Survey Report

MERRICK
 Engineers & Architects
 2450 S. Pearl Street Aurora, Colorado 80014 (303)751-0741
 Job Number: 50013142
 Date: October 27, 1998