

OK

540 774035-2

SET 5/8 INCH DIAMETER ROD WITH 2.5 INCH DIAMETER CAP, 0.5 BELOW GROUND, STAMPED "POTTAWATTAMIE CO. 1998, 540, 774035-2". LOCATED APPROXIMATELY 20 FEET WEST OF THE WEST EDGE OF 410TH STREET, 31 FEET NORTH OF THE NORTH EDGE OF ROSEWOOD ROAD, 13.5 FEET NORTH OF FENCE CORNER, 1.6 FEET EAST OF A ORANGE CARSONITE POST, 1.9 FEET EAST OF A NORTH-SOUTH FENCE. ON THE AVOCA NW 7.5 MINUTE QUADRANGLE.

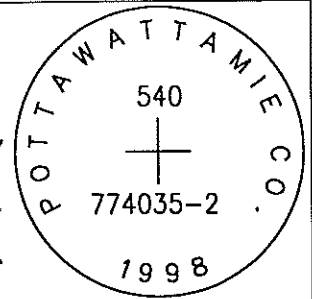

PT#	NAME OR DESIGNATION	GEODETIC NAD83 (1996)			HEIGHT ELLIPSOID METERS	SP NAD83 (1996) IOWA SOUTH HEIGHT			SP NAD83 (1996) IOWA SOUTH HEIGHT		
		LATITUDE (North) DEG MIN SEC	LONGITUDE (West) DEG MIN SEC			NORTHING METERS	EASTING METERS	NAVD88 METERS	NORTHING US FEET	EASTING US FEET	NAVD88 US FEET
540	774035-2	41 25 07.65196	95 24 11.74837	373.04	159296.698	340906.196	400.90	522625.92	1118456.41	1315.3	

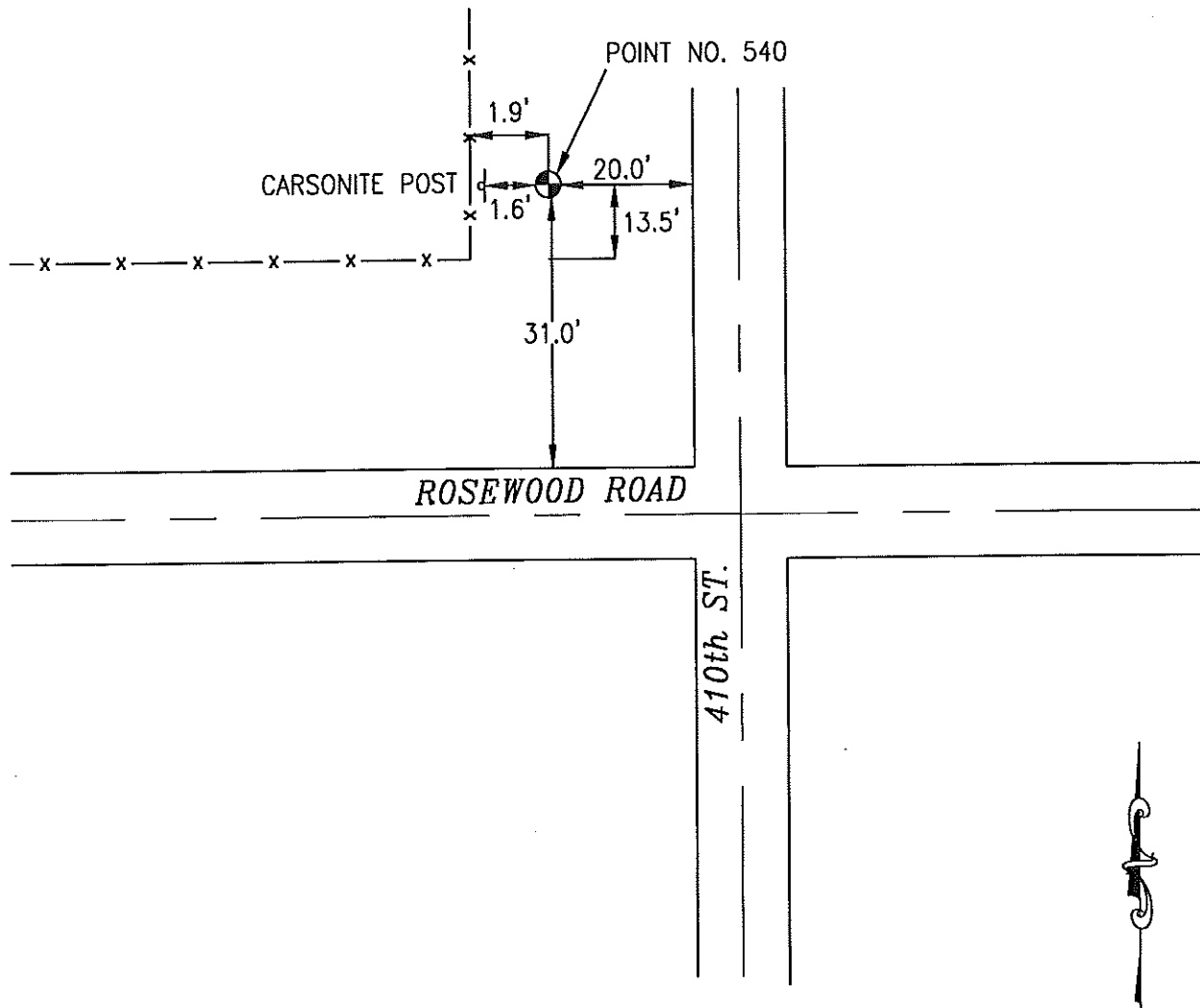

NOT TO SCALE

LOCATION DIAGRAM
 POTTAWATTAMIE COUNTY IOWA
 GIS Mapping Project
 GPS Survey Report

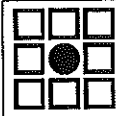

MERRICK
 Engineers & Architects

2450 S. Peoria Street Aurora, Colorado 80014 (303)751-0741
 Job Number: 50013142
 Date: October 27, 1998