

OK

550 764213-2

SET 5/8 INCH DIAMETER ROD WITH 2.5 INCH DIAMETER CAP, 0.3 BELOW GROUND, STAMPED "POTTAWATTAMIE CO. 1998, 550, 764213-2". LOCATED APPROXIMATELY 36 FEET SOUTH OF THE SOUTH EDGE OF MAGNOLIA ROAD, 19 FEET WEST OF THE WEST EDGE OF 295TH STREET, 7 FEET WEST OF STREET SIGN, 27 FEET SOUTHEAST OF BENTLEY SIGN, 3 FEET NORTHEAST OF CARSONITE POST. ON THE NEOLA 7.5 MINUTE QUADRANGLE.

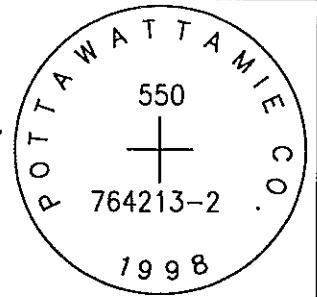

| PT# | NAME OR DESIGNATION | GEODEIC NAD83 (1996) | | HEIGHT ELLIPSOID METERS | SP NAD83 (1996) IOWA SOUTH HEIGHT | | | SP NAD83 (1996) IOWA SOUTH HEIGHT | | |
|-----|---------------------|------------------------------|------------------------------|-------------------------|-----------------------------------|----------------|---------------|-----------------------------------|-----------------|----------------|
| | | LATITUDE (North) DEG MIN SEC | LONGITUDE (West) DEG MIN SEC | | NORTHING METERS | EASTING METERS | NAVD88 METERS | NORTHING US FEET | EASTING US FEET | NAVD88 US FEET |
| 550 | 764213-2 | 41 22 36.93079 | 95 37 19.52116 | 356.65 | 155071.721 | 322504.567 | 384.59 | 508764.47 | 1058083.73 | 1261.8 |

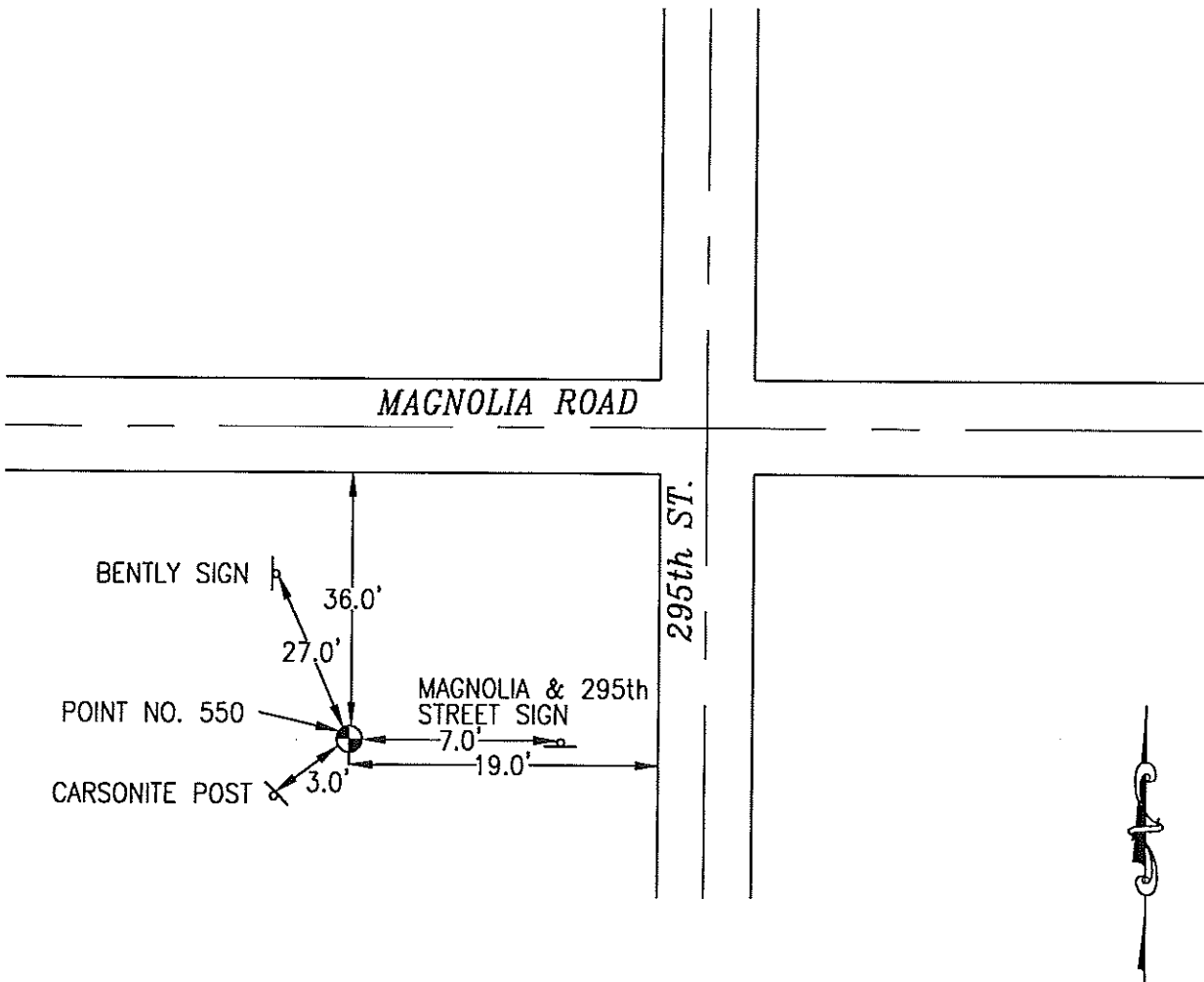

NOT TO SCALE

LOCATION DIAGRAM
POTTAWATTAMIE COUNTY IOWA
GIS Mapping Project
GPS Survey Report

MERRICK
Engineers & Architects
2450 S. Pearl Street Aurora, Colorado 80014 (303)751-0741
Job Number: 50013142
Date: October 27, 1998