

OK

561 764424-4

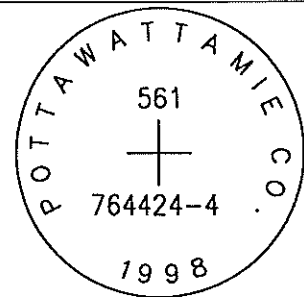

SET 5/8 INCH DIAMETER ROD WITH 2.5 INCH DIAMETER CAP, 0.3 FEET BELOW GROUND, STAMPED "POTTAWATTAMIE CO. 1998, 561, 764424-4". LOCATED APPROXIMATELY 19.8 FEET WEST OF THE WEST EDGE OF HIGHWAY 183, 3 FEET EAST OF AN ORANGE CARSONITE POST, 19 FEET NORTHWEST OF A POWERPOLE, NORTH OF THE TOWN OF CRESCENT, ACROSS THE HIGHWAY FROM RESIDENCE AT ADDRESS 1309. ON THE COUNCIL BLUFFS NORTH 7.5 MINUTE QUADRANGLE.

PT#	NAME OR DESIGNATION	GEODETIC NAD83 (1996)			HEIGHT ELLIPSOID METERS	SP NAD83 (1996) IOWA SOUTH HEIGHT			SP NAD83 (1996) IOWA SOUTH HEIGHT		
		LATITUDE (North) DEG MIN SEC	LONGITUDE (West) DEG MIN SEC			NORTHING METERS	EASTING METERS	NAVD88 METERS	NORTHING US FEET	EASTING US FEET	NAVD88 US FEET
561	764424-4	41 22 12.56452	95 51 29.39615	275.91	154828.847	302742.925	303.96	507967.64	993249.08	997.3	

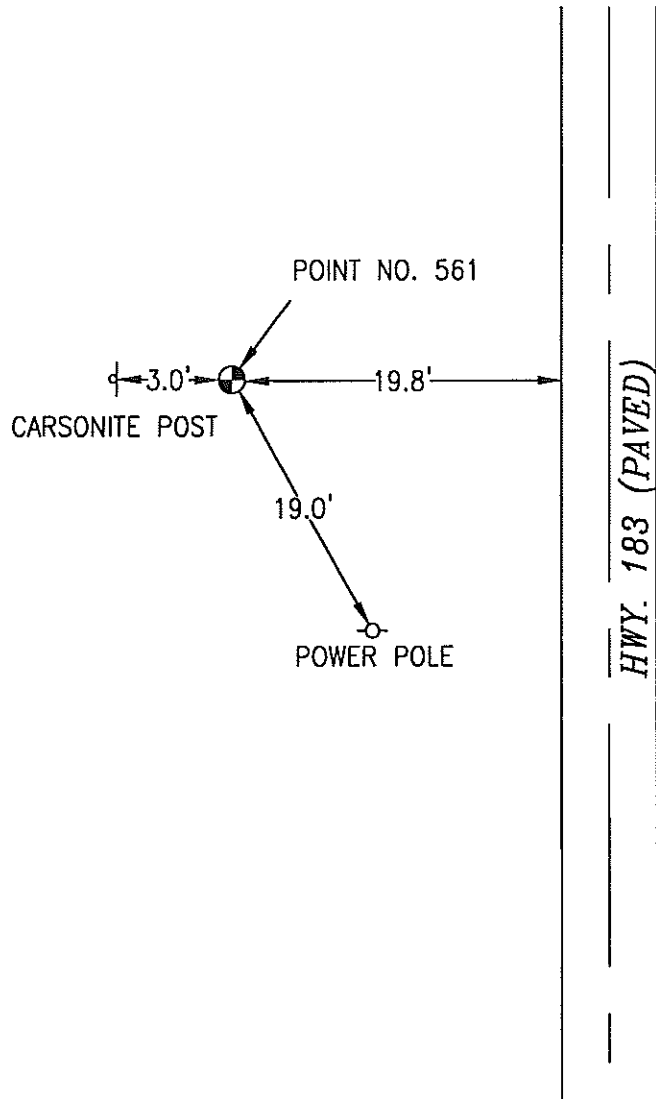

1311
Crescent
1309



NOT TO SCALE

LOCATION DIAGRAM
POTTAWATTAMIE COUNTY IOWA
GIS Mapping Project
GPS Survey Report

MERRICK
Engineers & Architects
2450 S. Peoria Street Aurora, Colorado 80014 (303)751-0741
Job Number: 50013142
Date: October 28, 1998