

OK

562 764329-2

SET 5/8 INCH DIAMETER ROD WITH 2.5 INCH DIAMETER CAP, 0.4 FEET BELOW GROUND, STAMPED "POTTAWATTAMIE CO. 1998, 562, 764329-2". LOCATED APPROXIMATELY 20 FEET SOUTH OF THE SOUTH EDGE OF BADGER AVENUE, 23 FEET EAST OF THE EAST EDGE OF MUDHOLLOW ROAD, 29 FEET NORTHEAST OF A STOP SIGN. ON THE COUNCIL BLUFFS NORTH 7.5 MINUTE QUADRANGLE.

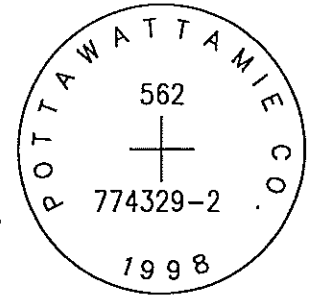

PT#	NAME OR DESIGNATION	GEODETIC NAD83 (1996)		HEIGHT ELLIPSOID METERS	SP NAD83 (1996) IOWA SOUTH HEIGHT			SP NAD83 (1996) IOWA SOUTH HEIGHT		
		LATITUDE (North) DEG MIN SEC	LONGITUDE (West) DEG MIN SEC		NORTHING METERS	EASTING METERS	NAVD88 METERS	NORTHING US FEET	EASTING US FEET	NAVD88 US FEET
562	764329-2	41 21 02.90059	95 48 30.48741	367.53	152569.044	306841.981	395.47	500553.61	1006697.40	1297.5

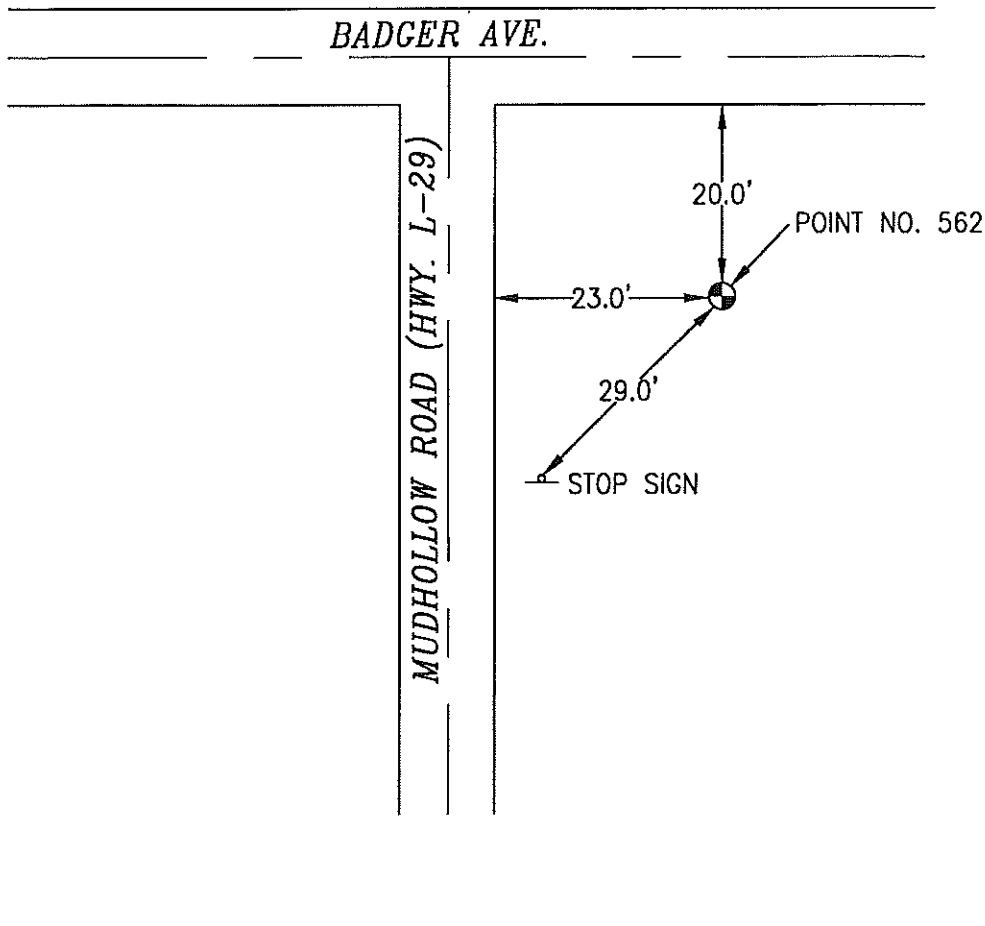

NOT TO SCALE

LOCATION DIAGRAM
 POTTAWATTAMIE COUNTY IOWA
 GIS Mapping Project
 GPS Survey Report

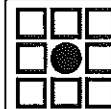

MERRICK

Engineers & Architects

2450 S. Peoria Street Aurora, Colorado 80014 (303)751-0741

Job Number: 50013142

Date: October 28, 1998